

BLACK+[®]DECKER



BUILT-IN DISHWASHER

**LAVE-VAISSELLE ENCASTRÉ
LAVAVAJILLAS EMPOTRABLE**

**USE AND CARE MANUAL
MANUEL D'UTILISATION ET
D'ENTRETIEN
MANUAL DE USO Y CUIDADO**

**CATALOG NUMBER
NUMÉRO DE CATALOGUE
NÚMERO DE CATÁLOGO**

BDW100M

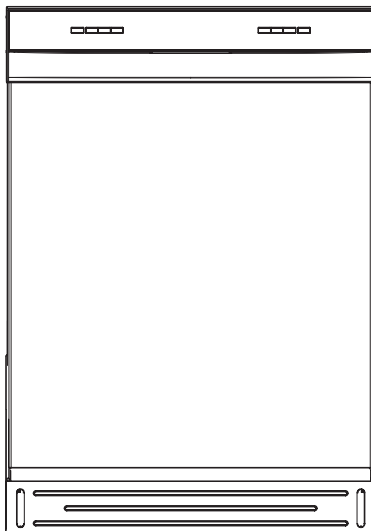

**Thank you for choosing BLACK+DECKER!
Merci d'avoir choisi BLACK+DECKER!
¡Gracias por elegir BLACK+DECKER!**

PLEASE READ BEFORE RETURNING THIS PRODUCT FOR ANY REASON.

**VEUILLEZ LIRE AVANT DE RETOURNER CE PRODUIT POUR QUELQUE
RAISON.**

**POR FAVOR, LEA ESTE MANUAL ANTES DE DEVOLVER EL PRODUCTO POR
CUALQUIER RAZÓN.**

If you have a question or experience a problem with your BLACK+DECKER purchase, go to www.blackanddecker.com/instantanswers. If you can't find the answer or do not have access to the Internet, call 844-299-0879 from 10:30 a.m. to 6:30 p.m. EST Mon. - Fri. to speak with an agent. Please have the catalog number available when you call.

Si vous avez une question ou rencontrez un problème avec votre achat Black+Decker, allez sur www.blackanddecker.com/instantanswers. Si vous ne trouvez pas la réponse ou n'avez pas accès à l'Internet, appelez au 844-299-0879 de 10h30 à 18h30 HNE du lun. au ven. pour parler avec un agent. Veuillez avoir le numéro de catalogue disponible lorsque vous appelez.

Si tiene una pregunta o experimenta un problema con tu compra de BLACK+DECKER, vaya a www.blackanddecker.com/instantanswers. Si no puede encontrar las respuestas que necesita o no tiene acceso a Internet, llame al 844-299-0879 desde las 10:30 a.m. a las 6:30 p.m. EST de lunes a viernes para hablar con un agente. Por favor, tenga el número de catálogo a mano cuando llame.

**SAVE THIS MANUAL FOR FUTURE REFERENCE.
CONSERVEZ CE MANUEL POUR TOUTE CONSULTATION ULTÉRIEURE.
GUARDE ESTE MANUAL PARA SU REFERENCIA FUTURA.**

PRODUCT REGISTRATION

Thank you for purchasing our BLACK+DECKER product. This easy-to-use manual will guide you in getting the best use of your product.

Remember to record the model and serial numbers. They are on a label on the rear.

Model number

Serial number

Date of purchase

Staple your receipt to your manual.
You will need it to obtain warranty service.

SAFETY INFORMATION



DANGER

DANGER - Immediate hazards which **WILL** result in severe personal injury or death



WARNING

WARNING - Hazards or unsafe practices which **COULD** result in severe personal injury or death



CAUTION

CAUTION - Hazards or unsafe practices which **COULD** result in minor personal injury

IMPORTANT SAFETY INSTRUCTIONS



WARNING

When using your dishwasher, follow basic precautions, including the following

1. READ ALL INSTRUCTIONS BEFORE USING THE DISHWASHER
2. Use the dishwasher only for its intended function.
3. Use only detergents or wetting agents recommended for use in a dishwasher and keep them out of the reach of children.
4. When loading items to be washed:
 - 1) Locate sharp items so that they are not likely to damage the door seal;
 - 2) Warning: Knives and other utensils with sharp points must be loaded in the basket with their points down or placed in a horizontal position.
5. Check that the detergent receptacle is empty after completion of the wash cycle.
6. Use only detergent and rinse additives designed for an automatic dishwasher.
7. Never use soap, laundry detergent, or hand washing detergent in your dishwasher. Keep these products out of the reach of children.
8. Keep children away from detergent and rinse aid. Keep children away from the open door of the dishwasher, there could still be some detergent left inside.
9. This appliance is not intended for use by persons (including children) with reduced physical, sensory or mental capabilities, or lack of experience and knowledge, unless they have been given supervision or instruction concerning use of the appliance by a person responsible for their safety.
10. Children should be supervised to ensure that they do not play with the appliance.
11. Dishwasher detergents are strongly alkaline, they can be extremely dangerous if swallowed. Avoid contact with skin and eyes and keep children away from the dishwasher when the door is open.
12. The door should not be left in the open position since this could present a tripping hazard.

SAFETY INFORMATION

13. If the supply cord is damaged, it must be replaced by the manufacturer or its service agent or a similarly qualified person in order to avoid a hazard.
14. Remove the door to the washing compartment when removing an old dishwasher from service or discarding it.
15. Please dispose of packing materials properly.
16. Use the dishwasher only for its intended function.
17. During installation, the power supply must not be excessively or dangerously bent or flattened. Do not tamper with controls.
18. The appliance is to be connected to the water mains using new hose sets and that old hose-sets should not be reused.
19. The maximum number of place settings to be washed is 12.
20. Do not use this dishwasher outdoors.
21. This appliance must be properly installed in accordance with the installation instructions before its use.
22. This appliance must be connected to a proper electrical outlet with the correct electrical supply.
23. Disconnect electrical power and water intake hose to dishwasher before cleaning and/or servicing.
24. Under certain conditions, hydrogen gas may be produced in a hot-water system that has not been used for two weeks or more. **HYDROGEN GAS IS EXPLOSIVE.** If the hot-water system has not been used for such a period, before using the dishwasher turn on all hot-water faucets and let the water flow from each for several minutes. This will release any accumulated hydrogen gas. As the gas is flammable, do not smoke or use an open flame during this time.
25. Do not wash plastic items unless they are marked as dishwasher safe. For plastic items not so marked, check the manufacturer's recommendations.
26. Do not touch the HEATING ELEMENT during or immediately after use.
27. Do not operate your dishwasher unless all ENCLOSURE panels are properly in place.
28. Do not tamper with controls.
Do not abuse, sit on, or stand on the door or dish rack of the dishwasher.

SAVE THESE INSTRUCTIONS
HOUSEHOLD USE ONLY
GROUNDING INSTRUCTIONS

SAFETY INFORMATION

ELECTRICAL REQUIREMENTS

This appliance must be grounded. In the event of a malfunction or breakdown, grounding will reduce the risk of electric shock by providing a path of least resistance for electric current. This appliance is equipped with a cord having an equipment-grounding conductor and a grounding plug. The plug must be plugged into an appropriate outlet that is installed and grounded in accordance with all local codes and ordinances.

WARNING

Improper connection of the equipment-grounding conductor can result in a risk of electric shock. Check with a qualified electrician or service representative if you are in doubt whether the appliance is properly grounded. Do not modify the plug provided with the appliance, if it will not fit the outlet, have a proper outlet installed by a qualified electrician.

POWER SUPPLY CORD

- If the power supply cord is too short, do not use an extension cord.
Have a qualified electrician or serviceman install an outlet near the appliance.

SET UP & USE

INSTALLATION INSTRUCTIONS

WARNING

Electrical Shock Hazard - Disconnect electrical power before installing dishwasher.
Failure to do so can result in death or electric shock.

CAUTION: The installation of the pipes and electrical equipment should be done by professionals.

The installation position of dishwasher should be near the existing inlet and drain hoses and power cord.

One side of the cabinet sink should be chosen to facilitate the connection of drain hoses of the dishwasher.

Position the appliance in the desired location. The back should rest against the wall behind it, and the sides, along the adjacent cabinets or wall. The dishwasher is equipped with water supply and drain hoses that can be positioned to the right or the left to facilitate proper installation.

 **WARNING:** DO NOT USE AN EXTENSION CORD OR AN ADAPTER PLUG WITH THIS APPLIANCE.
DO NOT, UNDER ANY CIRCUMSTANCES, CUT OR REMOVE THE GROUND CONNECTION FROM THE POWER CORD.

WARNING

Tip Over Hazard

- Do not use dishwasher until completely installed.
- Do not push down on open door.
- Doing so can result in serious injury or cuts.

State of California Proposition 65 Warnings:

 **WARNING:** Cancer and Reproductive Harm
www.P65Warnings.ca.gov.

SET UP & USE

WARNING

Suffocation Hazard-Before you throw away your old appliance, remove the door or lid so that children cannot hide or get trapped inside your old appliance. Failure to follow these instructions can result in death or brain damage.

CAUTION:

- Never use harsh chemicals to clean your dishwasher. Some chloride-containing products can damage your dishwasher and may present health hazards!
- Never use steam cleaning products to clean your dishwasher. The manufacturer will not be responsible for the possible damages or consequences.
- To avoid possible dishwasher damage, do not use harsh chemicals, abrasive cleaners, scouring pads (metal or plastic), or abrasive cloths/paper towels to clean your dishwasher's exterior door panel. Your dishwasher's exterior door panel can be damaged by doing so.
- It is highly recommended that the user become familiar with the procedure to shut off the incoming water supply and the procedure to shut off the incoming power supply. See the Installation Instructions or contact your installer for more information.
- If the dishwasher drains into a food disposer, make sure disposer is completely empty before running dishwasher.
- NSF/ANSI 184 Certified residential dishwashers are not intended for licensed food establishments.
- Protect your dishwasher from the elements. Protect against freezing to avoid possible damage to the fill valve. Damage caused by freezing is not covered by the warranty.
- Not for outdoor use.

SET UP & USE

OPERATING REQUIREMENTS

ELECTRICAL REQUIREMENTS

WARNING

Electrical Shock Hazard-

- Electrically ground dishwasher.
- Connect ground wire to green ground connector in terminal box.
- Do not use an extension cord.
- Failure to follow these instructions can result in death, fire, or electrical shock.

This dishwasher is designed for operation on an adequately wired individual 120 V, 60 Hz, 15- or 20-amp fused electrical supply with copper wire only. It is recommended that a time-delay fuse or circuit breaker is used, and that a separate circuit serving only this appliance is provided. If an outlet is used, the outlet should be placed in adjacent cabinet.

LOCATION REQUIREMENTS

- Install where dishwasher is protected from the elements. Protect against freezing to avoid possible rupture of fill valve. Such ruptures are not covered by the warranty. For winter storage information, see “Storing” in the “Dishwasher Care” section.
- Install and level dishwasher on a floor that will hold the weight and in an area suitable for its size and use.

WATER SUPPLY REQUIREMENTS

- The water supply temperature should be 120°F to 150°F (49°C to 66°C).
- The water supply must maintain water pressure between 20 and 80 psi for sufficient flow.

SET UP & USE

PARTS AND FEATURES

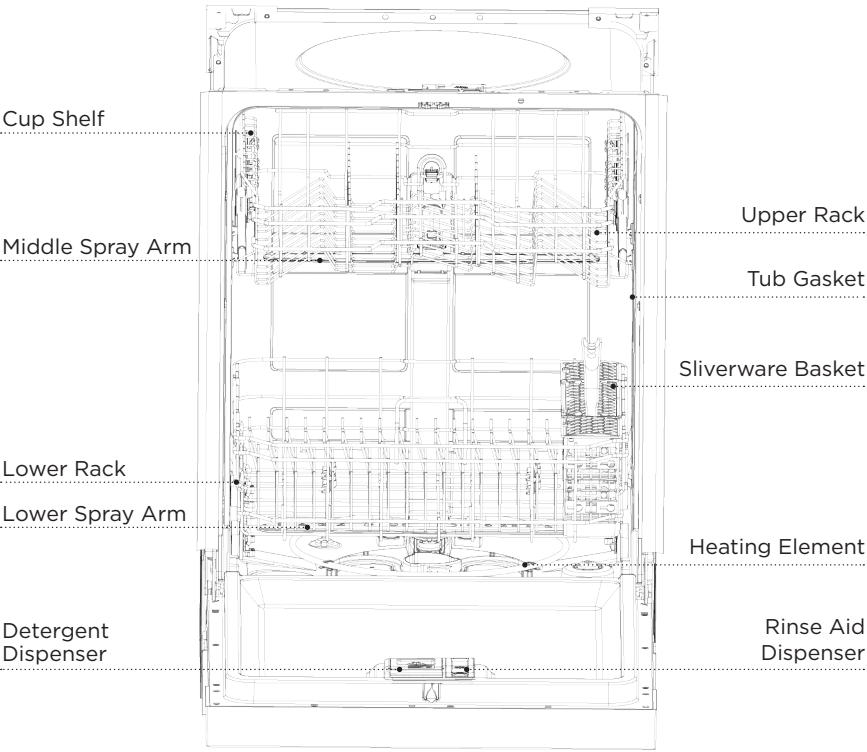

SPECIFICATIONS	
Capacity:	12 Place Settings
Dimensions (WxDxH):	23 3/5" x 22 7/10" x 33 3/4" (600x576x855mm)
Weight Unpacked:	81.35 lb (36.9kg)
Power Supply:	120 volts, 60 Hz
Rated Power Usage:	Wash motor 50 W Heater 840 W
Water Feed Pressure:	20 - 80 psi (138 - 552 kPA)

SET UP & USE

FILTER SYSTEM

Your dishwasher has a multiple filter system, which helps your dishwasher perform better using less water and less energy.

The filter system includes three filters that work in combination to separate dirty and clean water into different chambers.

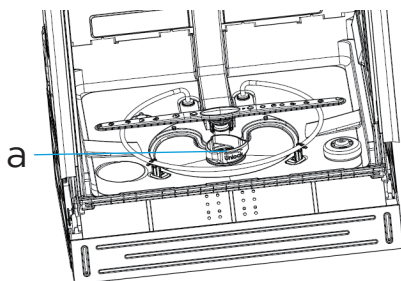

a Filter Location

SMART WASH SYSTEM

Your dishwasher has a Smart Wash system which can be used by selecting the Auto cycle.

The Smart Wash system senses the soil level of the load and adjusts the wash cycle accordingly. Your dishwasher can determine the type of cycle required to clean the dishes and will clean more efficiently every time.

ADJUSTABLE UPPER RACK

The Adjustable Upper Rack feature allows you to load taller items in either the upper or lower rack.

The upper rack of your dishwasher can be adjusted 2" (5.08 cm).

Adjusting the clearance of the Upper Rack increases or decreases the clearance of the lower rack, as shown.

For instructions, see the "Adjustable Upper Rack" section.

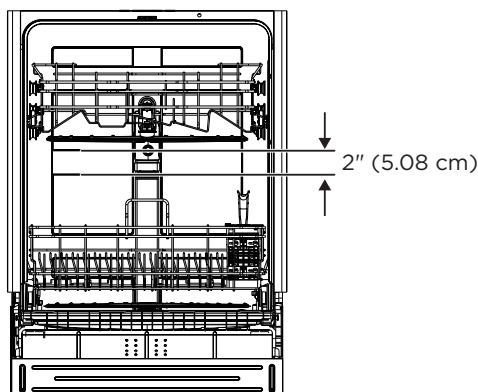

SET UP & USE

START UP GUIDE

IMPORTANT!

- Properly dispose of/recycle all packing material.
- Read this entire User Manual. You will find important safety information and useful operating tips.

HOW YOUR DISHWASHER CLEANS

Your dishwasher cleans by spraying a mixture of hot water and detergent through the spray arms against soiled surfaces.

The dishwasher fills with water covering the filter area. Water is then pumped through the multiple filters and spray arms. Soil particles are separated from the water and go down the drain as the water is pumped out and replaced with clean water.

The number of water fills will vary depending on the cycle selected.

BEFORE USING YOUR DISHWASHER

1. Check the filters for debris that may have been introduced from the packaging or during installation. See the "Clean Filters" section.
2. Add Rinse Aid. See "Proper Use of Rinse Aid."

USING YOUR NEW DISHWASHER

NOTE: To decrease cycle time and possibly improve performance, turn on the hot water faucet nearest to the dishwasher until the water runs hot. Turn off the water.

1. Load dishwasher. See "Dishwasher Loading."
2. Add detergent. See "Proper Use of Detergent."
3. Select desired CYCLE and OPTIONS. See "Cycle and Option Charts."
 - Only the Options available for the Cycle selected will illuminate.
 - The controls of the selected Cycle and Options will glow to indicate they are selected.
4. Close the door firmly to latch.
5. Press START.

SET UP & USE

CONTROLS

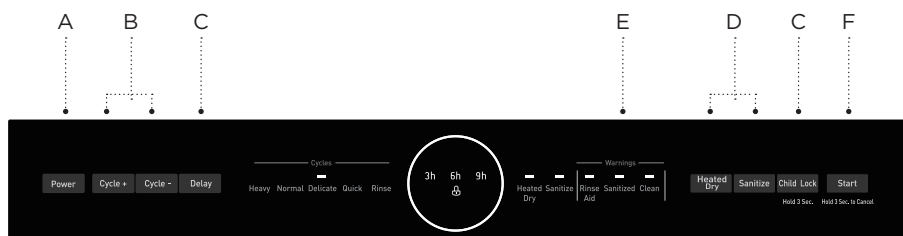

NOTE: when the door is closed.

A. Power

Press this button to turn on or turn off the dishwasher.

B. Cycle+ / Cycle-

Press this button to select corresponding washing program code.

Cycle+: Heavy→Normal→Delicate→Quick→Rinse→Heavy

Cycle-: Heavy→Rinse→Quick→Delicate→Normal→Heavy

Heavy

Heavy cycle is for pots, pans, casseroles and dinnerware with dried-on or baked on soil.

Normal

Normal cycle with only the Heat Dry option selected is recommended to completely wash and dry a full load of normally soiled dishes. The energy usage label is based on this cycle and option combination with the upper rack in the raised position.

Delicate

Delicate cycle is for items that need special care such as stemware or porcelain.

Quick

Quick cycle is for lightly soiled or well-rinsed dish loads.

Rinse

Use for pre-rinsing dishes or glasses. This is only a rinse that keeps food from drying on your dishes and reduces odor buildup in your dishwasher until you are ready to wash a full load.

C. ADDITIONAL FEATURES

Delay

The Delay Time feature allows you to program the dishwasher to begin the selected wash cycle 3, 6 or 9 hours later.

Press the DELAY control repeatedly to toggle between (3h/6h/9h). The LED next to the selected time will illuminate.

NOTE: To cancel the Delay feature, press and hold the START control for 3 seconds to Cancel. To begin the wash cycle immediately, press START again.

SET UP & USE

Child Lock

Use to lock all controls and prevent children from accidentally changing the dishwasher cycle or starting the dishwasher.

- Press and hold for 3 seconds Child Lock to either activate or cancel the Child Lock option. After the function is selected the control lock icon will illuminate. If the function is cancelled, the control lock icon will go off.

D. OPTIONS

Options enhance the wash cycle. Some Options are available with only certain Wash Cycles. Refer to the "Cycle and Options Charts" to see which Options are available for the wash cycle you selected.

- Press the desired Option control(s). The Option control(s) illuminates to indicate which option(s) have been selected.

Sanitize

⚠ WARNING: Only sanitizing cycles have been designed to meet the requirements for soil removal and sanitization efficacy. There is no intention, either directly or indirectly, that all cycles on a certified machine have passed the sanitization performance test.

The sanitize option sanitizes dishes and glassware in accordance with NSF International NSF/ANSI Standard 184 for Residential Dishwashers. Certified residential dishwashers are not intended for use in licensed food establishments.

When the Sanitize option is selected, the water temperature will reach 156.2°F (69°C) maximum.

The Sanitize Control illuminates to indicate when the Wash cycle with the Sanitize option is completed. The light will turn off after the door has been opened for 30 seconds.

NOTE: It is possible that the water will not reach 156°F (69°C) in the Sanitize mode if the temperature of the incoming hot water does not meet the minimum requirement of 120°F (49°C).

Heated Dry

When the Heated Dry option is selected, the heater will work during the drying process.

E. INDICATOR LIGHTS

Rinse Aid

The Rinse Aid indicator light illuminates when the rinse aid level is low. Rinse Aid should be added to the Rinse Aid dispenser.

Sanitized

The Sanitized indicator light illuminates when using the Sanitize option is finished.

The light turns off when the door is opened and then closed or when any button is pressed.

Clean

Turns on after a cycle is finished. Turns off when the door is opened and then closed or when any button is pressed.

SET UP & USE

F. START

The cycle will begin. Start - Close the door and press Start.

PAUSE - If you need to pause or cancel a dishwasher cycle in process:

IMPORTANT!

Open the door slightly, and then wait for the spray arms and wash action to stop before opening the door completely. Doing this will help keep you from being splashed with hot water.

1. Open the door slightly and wait a few seconds until the wash action stops.
2. Open the door to add or remove items.
3. Close the door and then Press START to resume the wash cycle.

CANCEL - To cancel a cycle when the dishwasher is running, press and hold Start for 3 seconds.

CYCLE AND OPTION CHARTS

Depending on the Cycle selected, the Options available for selection will illuminate.

Cycle times are approximate and will vary depending on the wash cycle and options selected.

NOTE: Added Options can add more time and use more water.

Hot Water is necessary to activate the dishwasher detergent and melt fatty food residue.

An automatic sensor checks the temperature of the incoming water. If the water is not hot enough, the cycle will be lengthened to heat the water for the main wash.

The Smart Wash Sensor detects the soil level of the dish load and may increase or decrease cycle time depending on the number of water fills required to clean the load.

Cycle	Options Available	Water Usage	Cycle Time
Heavy	Heated Dry Sanitize	7.13 gal. 27 L	151 mins.
Normal	Heated Dry Sanitize	3.04-7.04gal. 11.5-26.6 L	108-146 mins.
Delicate	Heated Dry Sanitize	7.0gal. 26.5L	118 mins.
Quick	Heated Dry Sanitize	4.11gal. 15.5L	60 mins.
Rinse	N/A	2.0gal. 7.6 L	20 mins.

SET UP & USE

DISHWASHER LOADING

PREPARE DISHES

- Empty liquids from glasses and cups.
- Remove leftover food, bones, toothpicks and other hard items from the dishes and discard.
- It is not necessary to hand-rinse dishes before loading them into the dishwasher with the following exceptions:
- Foods such as mayonnaise, mustard, vinegar, lemon juice and tomato-based products may discolor stainless steel and plastics if allowed to remain on them for any length of time.
- Burned-on foods should be loosened before loading the cookware into the dishwasher.

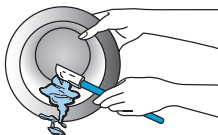

LOAD DISHES

- It is **IMPORTANT** for the water spray to reach all soiled surfaces.
- Load dishes so they are not stacked or overlapping if possible. For best drying results, water must be able to drain from all surfaces.
- Load heavy pots and pans carefully. Heavy items can dent the stainless steel interior of the door if they are dropped or bumped.
- Make sure pot lids and handles, pizza pans, cookie sheets, etc., do not interfere with the spray arm rotation.
- Make sure both the upper and lower spray arms are not blocked and move freely.

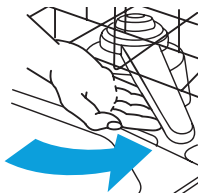

QUIET OPERATING TIPS

To avoid thumping/clattering noises during operation:

- Make sure lightweight items are secured in the racks.
- Make sure pot lids and handles, pizza pans, cookie sheets, etc., do not touch interior walls or interfere with the rotation of the spray arm.
- Load dishes so they do not touch one another.

NOTE: For built-in models, keep sink drain plugs closed during dishwasher operation to prevent noise transfer through drains.

SET UP & USE

UPPER RACK

The upper dishwasher rack is designed for cups, glasses, small plates, bowls and plastic items marked dishwasher safe.

The upper rack can be easily adjusted 2" (5 cm) up or down to accommodate taller items in either in the top or bottom rack.

ADJUST UPPER RACK

IMPORTANT!

- Remove all items before adjusting the rack. The rack must be empty. To adjust the height of the upper rack, follow these steps:

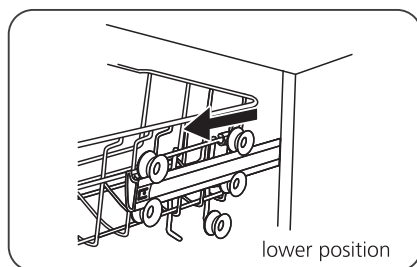

1 Pull out the upper basket.

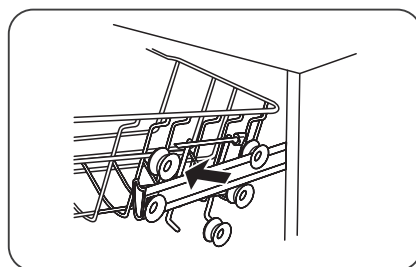

2 Remove the upper basket.

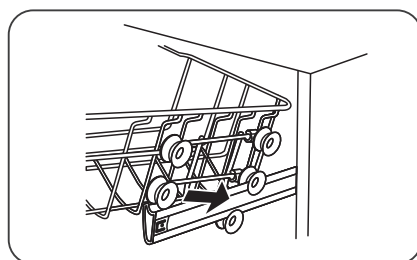

3 Re-attach the upper basket to upper or lower rollers.

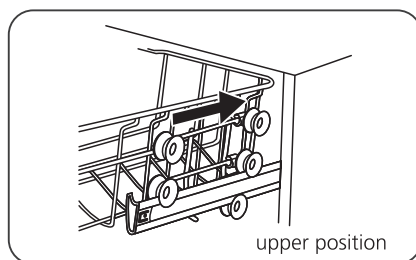

4 Push in the upper basket.

SET UP & USE

LOAD UPPER RACK

NOTE: The features on your dishwasher rack may vary from the drawings shown.

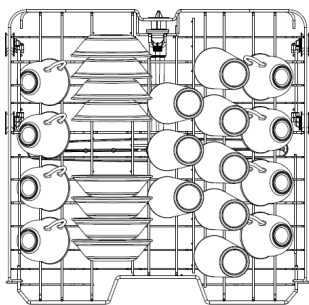

8 Place Settings

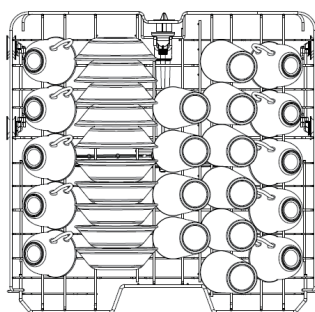

10 Place Settings

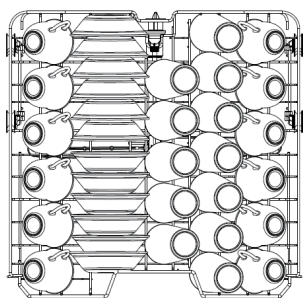

12 Place Settings

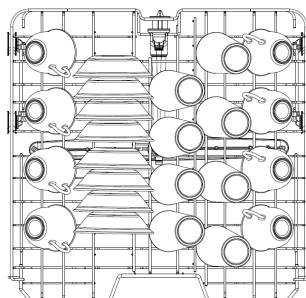

8 Place Settings(DOE)

IMPORTANT!

Make sure the items loaded in the upper rack do not interfere with the rotation of the middle spray arm located beneath the upper rack. Check for interference by turning spray arm by hand.

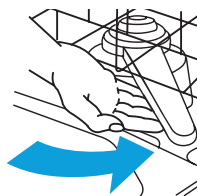

- Place items so that the open ends face downward for cleaning and draining.
- Load glasses and cups in upper rack only. The lower rack is not designed for glasses and cups. Damage can occur.
- Place cups and glasses in the rows between tines. Placing them over the tines can lead to breakage, water spots, and poor cleaning.
- Small bowls, pans and other utensils can be placed in the top rack. Load bowls in the center section for best stability.
- China, crystal and other delicate items must not touch each other during dishwasher operation. Damage may occur.
- Load plastic items so the force of the spray does not move them during the cycle.

SET UP & USE

LOWER RACK

The lower rack is designed for plates, soup bowls, cookware and bakeware.

The adjustable upper rack allows you to load items up to 12.6" in height in the lower rack.

IMPORTANT!

Items in the lower rack must be placed so that they do not interfere with the rotation of the spray arms, block the water inlet, or keep the water spray from reaching the detergent dispenser.

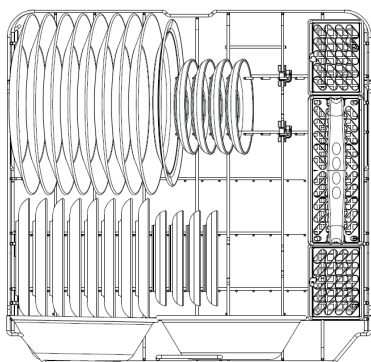

8 Place Settings

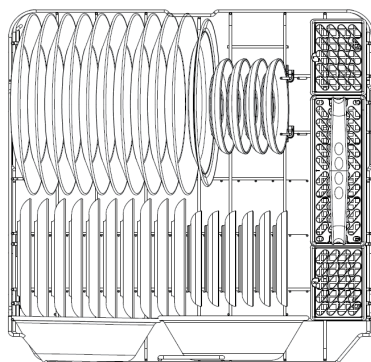

10 Place Settings

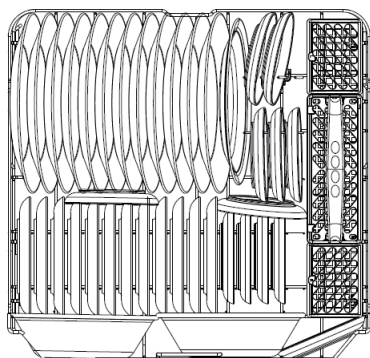

12 Place Settings

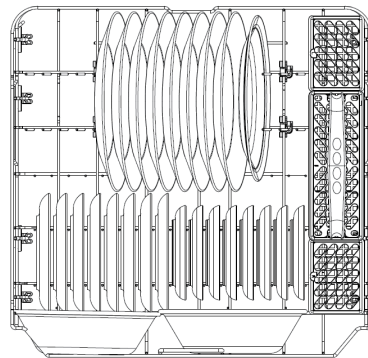

8 Place Settings(DOE)

SET UP & USE

LOAD LOWER RACK

NOTE: The features on your dishwasher rack may vary from the drawings shown.

- Do not load glasses, cups, or plastic items in the lower rack.
- Load small items in the lower rack only if they are secured in place.
- Load plates, soup bowls, etc. between tines. Do not nest bowls because the spray will not reach all surfaces.
- Do not load items between the bottom rack and the side of the dishwasher tub.
- Place heavily soiled cookware face down in the rack.

ADJUSTABLE RACK TINES

The fold-down tines in the lower rack make it easier to load extra large or hard-to-fit items such as serving bowls and roasters. The tines may be left in the up position for normal use, or folded down for more flexible loading.

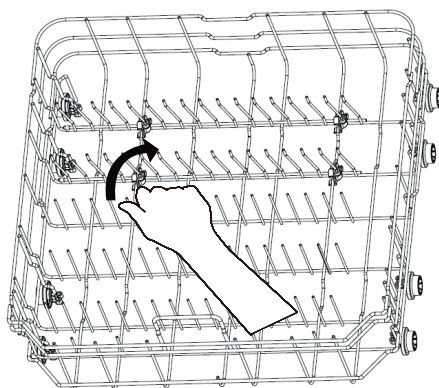

SET UP & USE

LOADING SILVERWARE

NOTES:

- Do not load silver or silver-plated silverware with stainless steel. These metals can be damaged by contact with each other during washing.
- Some foods (such as salt, vinegar, milk products, fruit juices, etc.), can pit or corrode silverware. DO NOT WASH ALUMINUM COOKWARE IN YOUR DISHWASHER.

THREE-PIECE SILVERWARE BASKET

The silverware basket consists of three separate sections. For optimum loading flexibility, the center section of the basket can be used individually, joined with one or both side sections or removed.

- Lift handle to remove the silverware basket and set the basket on a counter or table top.
- Lift up on each side section to disengage the center section from the keyhole slots in the side sections.
- Either replace the section(s) in the bottom rack and load the silverware, OR load the silverware while the section(s) are on the countertop and then replace the basket in the bottom rack.

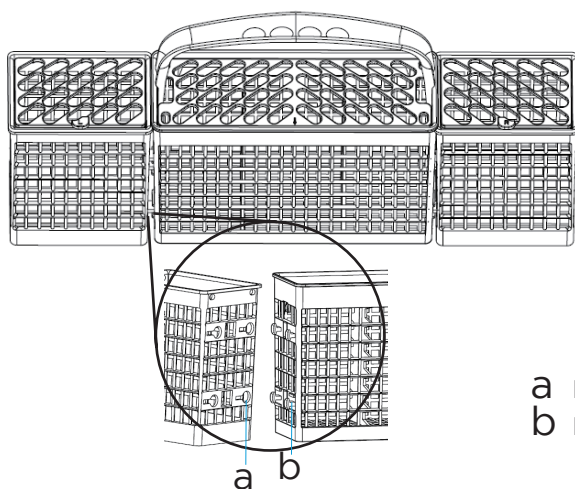

- a Keyhole Slots
b Prongs

SET UP & USE

For Best Results:

- Load items with handles down, using the separators to prevent silverware from nesting.
- Place small items such as baby bottle caps, jar lids, corncob holders, etc. in the section(s) with hinged cover(s). Close the cover to hold small items in place.
- Unload or remove the basket before unloading the racks to avoid water drops from falling on the silverware.
- With handles up, mix items in each section of the basket with some pointing up and some down to avoid nesting. Spray cannot reach nested items.

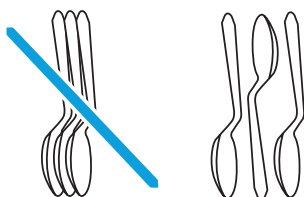

IMPORTANT!

Always load sharp items (knives, skewers, etc.) pointing down. Be sure that nothing protrudes through bottom of the basket or rack that may block the wash arm.



SET UP & USE

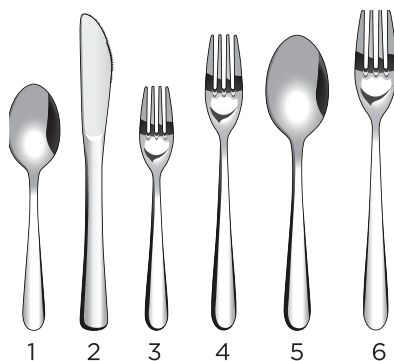

1. Spoons
2. Knives
3. Salad Forks
4. Forks
5. Large Spoons
6. Large Forks

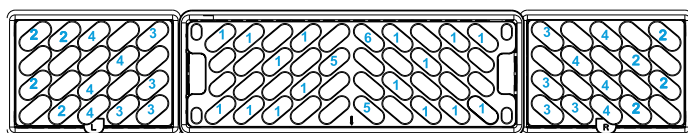

8 Place Settings

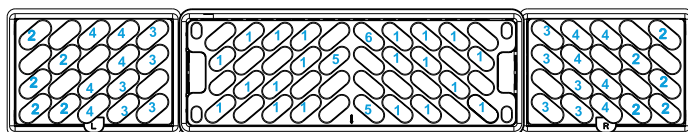

10 Place Settings

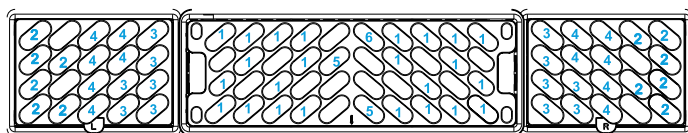

12 Place Settings

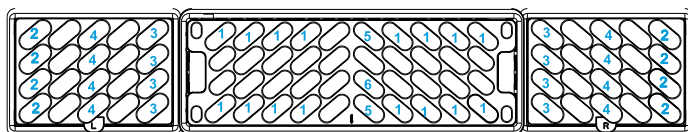

8 Place Settings(DOE)

SET UP & USE

DISHWASHER USE

PROPER USE OF DETERGENT

IMPORTANT!

- Use automatic dish washing detergent only. Other detergents can produce excessive suds that can overflow out of the dishwasher and reduce washing performance.
- Add detergent just before starting a cycle.
- Store detergent tightly closed in a cool, dry place. Fresh automatic dishwasher detergent results in better cleaning.

DETERGENT DISPENSER

1. Push the dispenser cover release catch to open the main wash detergent compartment.

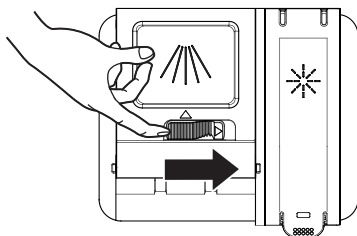

NOTE: The flap is always open at the end of a dishwashing cycle.

2. Add the recommended amount of detergent to the detergent compartment.

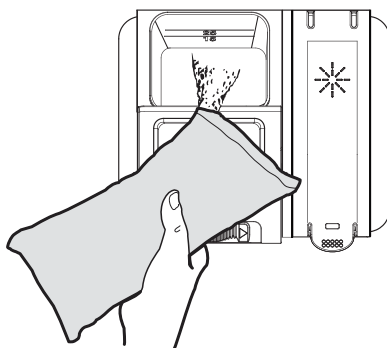

SET UP & USE

3. Press down on the top of the cover to secure.

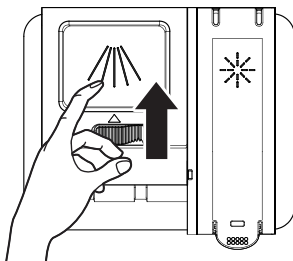

HOW MUCH DETERGENT TO USE

The amount of detergent to use depends on the soil level of your load, the type of detergent used and the hardness of your water.

- If you use too little detergent, dishes won't be clean.
- If you have soft water and use too much detergent, glassware will etch.

Water Hardness

Water hardness varies depending on your water source. For the best results, your dishwasher is designed to operate with water that has a hardness of no more than 7 grains per gallon. Test kits are available from all major appliance parts retail outlets. If your water has a hardness over 8 grains per gallon, you may consider installing a water softener or regularly use an additive to enhance the performance of your detergent.

PROPER USE OF RINSE AID

Rinse aid prevents water from forming droplets that can dry as spots or streaks. A small amount of the rinse aid is released into the final rinse water, which allows water to drain from the dishes.

Rinse aid greatly improves drying performance after the final rinse.

Your dishwasher is designed to use a LIQUID rinse aid. Do not use a solid or bar-type rinse aid.

RINSE AID DISPENSER

Under normal conditions, you will need to fill the rinse aid dispenser approximately once a month. Rinse aid is released through an opening in the dispenser. You do not need to wait until the dispenser is empty to refill it. Try to keep it full, but be careful not to overfill it.

SET UP & USE

To refill the rinse aid dispenser

1. Lift up the end tab of rinse aid cover to open.

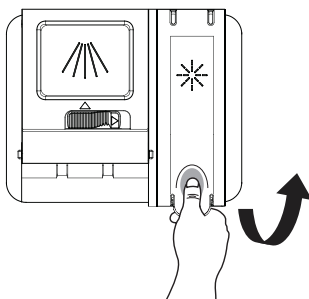

2. Fill the rinse aid dispenser with liquid rinse aid until full.

DO NOT overfill.

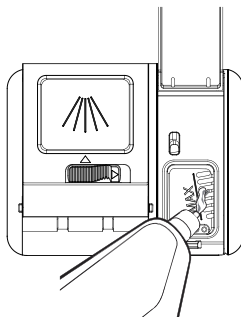

NOTE:

Use the viewing port when filling the rinse aid reservoir.

WARNING

DO NOT FILL THE RESERVOIR ABOVE THE FULL LEVEL INDICATOR.
EXCESS RINSE AID CAN OVERFLOW DURING THE WASH CYCLE.

3. Press the rinse aid cover down firmly to close.

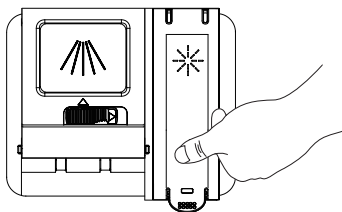

CLEANING & CARE

If you have doubts about washing a particular item, check with the dishware manufacturer to make sure it is dishwasher safe.

Material	Dishwasher Safe	Comments
Aluminum	Possible	High water temperature and detergents can affect finish of anodized aluminum. Unfinished aluminum will be discolored.
Disposable Aluminum	No	Do not wash disposable aluminum pans in the dishwasher. These might shift during washing and transfer black marks to dishes and other items.
Bottles and cans	No	Wash bottles and cans by hand. Labels attached with glue can loosen and clog the spray arms or pump and reduce washing performance.
Cast Iron	No	Seasoning will be removed and iron will rust.
China / Stoneware	Yes	Always check manufacturer's recommendations before washing. Antique, hand-painted, or over-the-glaze patterns may fade, gold leaf can discolor or fade.
Crystal	Yes	Check manufacturer's recommendations before washing. Some types of leaded crystal can etch with repeated washing.
Gold	No	Gold-colored flatware will discolor.
Glass	Yes	Milk glass yellows with repeated dishwasher washing.
Hollow-Handle Knives	No	Handles of some knives are attached to the blade with adhesive that can loosen if washed in the dishwasher.
Pewter, Brass, Bronze	No	High water temperatures and detergent can discolor or pit the finish.
Disposable Plastics	No	Cannot withstand high water temperatures and detergents.
Plastics	Yes	Always check manufacturer's recommendations before washing. Plastics vary in their capacity to withstand high temperatures and detergents. Load plastics in top rack only.
Stainless Steel	Yes	Run a rinse cycle if not washing immediately. Prolonged contact with food containing salt, vinegar, milk products, or fruit juice can damage finish.
Sterling Silver or Silver Plate	Yes	Run a rinse cycle if not washing immediately. Prolonged contact with food containing salt, acid, or sulfide (eggs, mayonnaise, and seafood) can damage finish.
Tin	No	Can rust.
Wooden Ware	No	Wash by hand. Always check manufacturer's instructions before washing. Untreated wood can warp, crack, or lose its finish.

CLEANING & CARE

DISHWASHER CARE

CLEANING

CLEANING THE EXTERIOR

In most cases, regular use of a soft, damp cloth or sponge and a mild detergent is all that is necessary to clean outside of your dishwasher. Clean the stainless steel door and handle regularly with a clean, soft cloth to remove debris.

IMPORTANT!

Do not use appliance wax, polish, bleach, or products containing chlorine to clean the stainless steel door.

Control Panel

Gently clean the control panel with a clean, soft cloth.

CLEANING THE INTERIOR

The tub is made of stainless steel designed to resist rust and corrosion if the dishwasher is scratched or dented.

Hard water minerals can cause a white film to build up on the inside surfaces, especially just beneath the door area.

Do not clean the dishwasher interior until it has cooled. Wear rubber gloves. Do not use any type of cleanser other than dishwasher detergent because it may cause foaming or create suds.

DOOR GASKET

Clean the steel inner door and tub with a clean, soft damp cloth.

Using a damp cloth, clean around the door gasket regularly to remove food particles.

CONTROL PANEL

Clean the Control Panel gently with a lightly dampened cloth.

CLEANING & CARE

CLEANING THE FILTERS

Check and clean the filters regularly for best performance.

1. Remove the lower dishwasher rack.
2. Rotate the Cylinder filter counterclockwise a quarter turn and lift up to remove.

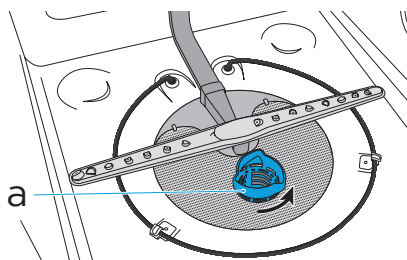

a Cylinder Filter

3. Empty the Cylinder filter and rinse it under running water.
4. Remove the Fine filter.

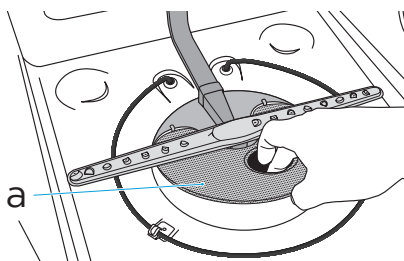

a Fine Filter

5. Remove the Micro filter from the bottom of the tub.

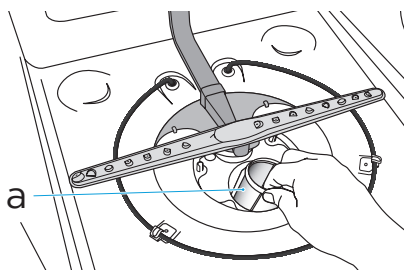

a Micro Filter

6. Inspect both the Fine filter and the Micro filter for debris, and then clean them by holding the filters under slow running water.

NOTE: A stiff, plastic bristle brush may be needed to remove some debris.

7. Reinstall the filters in reverse order making sure the Cylinder filter locks into place.

CLEANING & CARE

DRAIN AIR GAP

Check the drain air gap anytime your dishwasher isn't draining well. Some state or local plumbing codes require the addition of a drain air gap between a built-in dishwasher and the home drain system. If a drain is clogged, a drain air gap prevents water from backing up into the dishwasher.

The drain air gap is usually located on top of the sink or countertop near the dishwasher.

NOTE: The drain air gap is an external plumbing device that is not part of your dishwasher. The warranty provided with your dishwasher does not cover service costs directly associated with the cleaning or repair of the external drain air gap.

To Clean the Drain Air Gap:

Clean the drain air gap periodically to ensure proper drainage of your dishwasher. Follow the cleaning instructions provided by the manufacturer.

With most types:

1. Turn off the dishwasher.
2. Lift off the metal cover, and then unscrew the plastic cap.
3. Clean the plastic cap with a toothpick.

STORING

STORING FOR THE SUMMER

Protect your dishwasher during the summer months by turning off the water supply and power supply to the dishwasher.

WINTERIZING YOUR DISHWASHER

Protect your dishwasher and home against water damage caused by freezing water lines. If your dishwasher is left in a seasonal dwelling or could be exposed to near freezing temperatures, have your dishwasher winterized by authorized service personnel.

Prepare for Storage:

1. Turn off electrical power to the dishwasher.
2. Turn off the water supply.
3. Place a pan under the inlet valve, and then disconnect the water line from the inlet valve.
4. Disconnect the drain line from the pump and drain water into the pan.

Prepare for Use:

1. Reconnect the water, drain and electrical power supply.
2. Turn on water and electrical power supply.
3. Fill detergent cup and run the dishwasher through a heated wash cycle.
4. Check the connections for leaks.

TROUBLESHOOTING & WARRANTY

Troubleshoot your problem by using the chart below. If the appliance still does not work properly, contact W Appliance Co. customer service center or the nearest authorized service center. Customers must never troubleshoot internal components.

DISHWASHER NOT OPERATING PROPERLY

TROUBLE	POSSIBLE CAUSE	POSSIBLE REMEDY
Dishwasher does not run or stops during a cycle	There is no power to the dishwasher.	Replace fuse or reset circuit breaker.
	The door is not closed tightly and latched.	Close and latch the door.
	Most cycles pause for 5 minutes near the start of a cycle to let the dishes soak.	This is normal, and reduces the energy required to clean the dishes.
	Certain cycles repeatedly pause for 15 to 65 seconds during the main wash. The Delay feature is selected.	This is normal. To reset, see "Options" in the Controls section.
Dishwasher does not start a cycle	Control Lock feature is activated.	Deactivate Control Lock. See "Additional Features" in the Controls section.
Dishwasher will not fill	The water shutoff valve is not turned on.	Turn on the water valve.
	The door is not closed tightly and latched.	Close and latch the door.
	Water pressure is too low.	Verify a minimum of 20 psi water pressure is maintained during the filling operation.
Dishwasher seems to run too long	The water supplied to the dishwasher is not hot enough.	Run the water in the adjacent sink until it gets hot before turning on the dishwasher.
	The dishwasher runs longer while heating water and a delay automatically occurs in some wash and rinse cycles until the water reaches the proper temperature.	The cycle time increases to heat the water to the correct temperature for sanitizing.
	The Sanitize option is selected.	When heavy soil is detected, the Normal cycle will automatically increase the cycle time.
	The cycle time will vary depending on soil level. Dishwasher is connected to the Cold water supply.	Verify the dishwasher is connected correctly to the Hot water supply.

TROUBLESHOOTING & WARRANTY

TROUBLE	POSSIBLE CAUSE	POSSIBLE REMEDY
Water remains in the dishwasher. NOTE: A small amount of clean water around the outlet in the bottom of the tub is normal. It keeps the seal lubricated.	<p>The cycle is not complete or it is in a pause.</p> <p>The drain hose is kinked.</p> <p>The knockout plug is still in the garbage disposal.</p> <p>Drain hose is connected to the garbage disposal, and the garbage disposal is not empty.</p> <p>Drain is clogged.</p>	<p>The water will drain when the cycle is completed.</p> <p>Straighten the drain hose.</p> <p>Remove the knockout plug.</p> <p>Run the garbage disposal until it is empty.</p> <p>Check the air gap.</p>
Detergent remains in the dispenser	<p>The cycle has not completed.</p> <p>The detergent is damp or has clumped.</p> <p>An item was blocking the dispenser.</p> <p>The spray arm is blocked.</p>	<p>Close the door and press START to complete cycle.</p> <p>Remove detergent and replace with fresh dry dishwasher detergent.</p> <p>Remove item. Remove detergent and replace with fresh dry dishwasher detergent.</p> <p>Load the dishes in a manner that does not block the spray arm from rotating freely.</p>
Grinding, grating, crunching or buzzing sounds	A hard object or powder detergent granules have entered the wash module.	<p>IMPORTANT: Clear glass is hard to see in water and could result in a cut wound.</p> <p>Using care, remove the hard object. If the noise was caused by detergent granules, the noise should stop once the detergent is ground up.</p> <p>NOTE: If the noise persists after a complete cycle, call for service.</p>
Beeps	<p>Indicates the wash cycle is completed.</p> <p>NOTE: A rapid beep indicates an error condition.</p>	<p>This is normal.</p> <p>See "Error Codes" for further direction.</p>
Suds in the Tub	Used wrong type of detergent.	Use only detergent approved for automatic dishwashers.
Dishwasher Leaks	<p>Excessive suds caused by using improper detergent.</p> <p>Dishwasher is not level.</p>	<p>Use only detergent approved for automatic dishwashers.</p> <p>Level the Dishwasher. See Installation Instructions.</p>
Rinse Aid light is on	The Rinse Aid level is low.	Add liquid Rinse Aid.

TROUBLESHOOTING & WARRANTY

DISHES ARE NOT COMPLETELY CLEAN

TROUBLE	POSSIBLE CAUSE	POSSIBLE REMEDY
Food residue remains on the dishes	Dishwasher is not loaded correctly.	See "Dishwasher Loading."
	The wrong wash cycle for the dish load was selected.	Select the wash cycle based on the most difficult soil in the dishwasher load. If you have some items with heavier soils, use a heavier washing cycle.
	Water temperature is too low.	For best results, the temperature of the incoming water should be a minimum of 120°F (49°C).
	Used incorrect amount of detergent.	Use a minimum of 1 Tbsp. (15 g) detergent per load. Heavy soil and/or hard water generally requires additional detergent.
Food residue remains on the dishes (cont.)	Detergent is too old.	Detergent must be fresh to be effective. Store detergent in a cool, dry area.
	Detergent is caked in the dispenser.	Do not allow detergent to sit for several hours in a wet dispenser. Clean dispenser and refill with fresh, dry detergent.
	The pump or spray arm is clogged with labels from bottles and cans.	Check pump and spray arm for labels and remove the labels.
	The pressure of the water coming into the home is too low.	Water pressure should be 20 to 80 psi (138 to 552 kPa) for proper dishwasher fill. A booster pump on the water supply can be added if pressure is too low.
	High suds are slowing the wash arm.	Use only detergent recommended for the dishwasher. Do not use soap or laundry detergents.

TROUBLESHOOTING & WARRANTY

SPOTS AND STAINS ON DISHES

TROUBLE	POSSIBLE CAUSE	POSSIBLE REMEDY
Spotting and filming on dishes	Rinse Aid dispenser is empty.	Add a liquid rinse aid to the dispenser.
	Hard water. High mineral content in your water.	Use a rinse aid and keep the dispenser filled to help eliminate spotting and filming. Increase setting on Rinse aid dispenser 1 number per cycle until spotting is eliminated. NOTE: If your water hardness or above, it is strongly recommended that you install a home water softener.
	Water temperature is too low.	For best results, water should be a minimum 120°F (49°C) as it enters the dishwasher.
	Did not use enough detergent.	Use a minimum of 1 Tbsp. (15 g) of detergent per load. Heavy soil and/or hard water generally require extra detergent.
Spotting and filming on dishes (cont.)	Detergent is too old.	Detergent must be fresh and dry to be effective. Store detergent in a cool, dry area.
	Home water pressure is too low to fill dishwasher properly.	Water pressure to the home should be 20 to 80 psi (138 to 552 kPa) for proper dishwasher fill. A booster pump on the water supply can be added if pressure is too low.
Silica film or etching	Using too much detergent.	If you have soft water use less detergent, but do not use less than 1 Tbsp. (15 g) per load.
	The inlet water temperature exceeds 150°F (65°C).	Lower the incoming water temperature.
Black or gray marks on dishes	Aluminum items rubbing dishes during washing. Disposable aluminum items can break down in the dishwasher and cause marking.	Hand wash aluminum items. Remove aluminum markings by using a mild abrasive cleaner.
Orange stains on plastic dishes or dishwasher interior	Large amounts of tomato-based foods on dishes placed in the dishwasher.	Use a stain removal product to remove stains from your dishwasher. Stains will not affect dishwasher performance.

TROUBLESHOOTING & WARRANTY

DISHES DO NOT DRY COMPLETELY

TROUBLE	POSSIBLE CAUSE	POSSIBLE REMEDY
Dishes are not completely dry. NOTE: Plastics often need towel drying.	Dishes are not loaded properly to allow water drainage.	Do not overload dishwasher. Place glasses and cups in the rack so that the bottom surface is slanted to allow water to run off.
	Rinse Aid not used or dispenser is empty.	Use a liquid rinse aid to speed drying and keep the dispenser full.
	Used an air dry or energy-saving option.	For dryer dishes, select a Cycle that allows a Heated Dry option.

DISHES ARE DAMAGED DURING A CYCLE

TROUBLE	POSSIBLE CAUSE	POSSIBLE REMEDY
Dishes are chipped. NOTE: Some types of china and glassware might be too delicate for automatic dish washing. Wash by hand.	Dishes not loaded properly.	Load the dishes and glasses so they are stable and will not strike together from washing action.
	Moving the rack in or out of the dishwasher too quickly.	Minimize chipping by moving the rack in and out slowly.

TROUBLESHOOTING & WARRANTY

ERROR CODES

When some malfunctions come on, the appliance will display error codes to warn you:

CODES	MEANINGS	POSSIBLE CAUSE	
Rinse light flashes and dishwasher beeps for 30 seconds	Either the water flow is insufficient, or the water pressure from the incoming line is too high.	<ul style="list-style-type: none">• Faucet is not opened.• Water pressure is too low.• The drain hose is plugged.• Other (parts failure of inlet or drain system).	<ul style="list-style-type: none">• Make sure that the water is turned on to the dishwasher.• Make sure that the water pressure is 20-100 psi.• Check the drain hose.• Contact Customer Service.
Delicate light flashes and dishwasher beeps for 30 seconds	Overflow or leak sensor activated	<ul style="list-style-type: none">• A leak• Too much water in the tub	Turn off water to the dishwasher, then check the filter system for blockage. Unblock if necessary. If there is no water in the tub, contact Customer Service
Normal, Delicate, and Rinse lights flash and dishwasher beeps for 15 seconds	Communication exception or issue	The display board can't receive or the main board can't send a signal for over 20 seconds.	Contact Customer Service.

LIMITED WARRANTY

ACTIVATE WARRANTY

Any repair, replacement, or warranty service, and all questions about this product should be directed to W Appliance Co. at 844-299-0879 from the US, including Puerto Rico, or Canada.

Some issues can be addressed without service. Before contacting regarding your warranty, please visit the "Troubleshooting" section of your user manual.

All warranty service is provided exclusively by our authorized W Appliance Co. service providers. For service in US, including Puerto Rico, and Canada call 1-844-299-0879 to create a ticket. When calling, please have the following information available: date of purchase, model number, proof of purchase and a brief description of the problem.



WHAT IS COVERED

YOUR SOLE AND EXCLUSIVE REMEDY UNDER THIS LIMITED WARRANTY SHALL BE PRODUCT REPAIR AS PROVIDED HEREIN. This limited warranty is valid only in the United States or Canada and applies only when the major appliance is used in the country in which it was purchased:

ONE (1) YEAR FROM THE DATE OF DELIVERY OF THE ORIGINAL PURCHASE (PARTS AND LABOR INCLUDED):

W Appliance Co. will pay for factory-specified replacement parts and labor to correct defects in materials or workmanship that existed when this major appliance was purchased, or at its sole discretion, replace the product with a new, or remanufactured, unit equivalent to your original purchase. In the event of product replacement, your appliance will be warranted for the remaining term of the original unit's warranty period.

YEARS TWO (2) THROUGH FIVE (5) FROM DATE OF DELIVERY OF THE ORIGINAL PURCHASE (CERTAIN COMPONENT PARTS ONLY - LABOR NOT INCLUDED): W Appliance Co. will pay for factory-specified replacement parts for the component parts listed below to correct non- cosmetic defects in materials or workmanship in these parts that prevent function of this major appliance and that existed when this major appliance was purchased:

DISHWASHER	WASHING MACHINE	DRYER	REFRIGERATORS AND FREEZERS	MICROWAVE
Lower, Upper and Third Level (where applicable) Wire Racks (excludes cup shelves, silverware basket, and third rack trays), Chopper Blade, Stainless Steel Tub and Inner Door Liner	Drive Motor (Stator and Rotor Only)	Drive Motor Only	Compressor Only	Magnetron Tube Only

LIMITED WARRANTY

WHAT IS NOT COVERED / EXCLUSIONS

1. Commercial, non-residential or multiple family use or use inconsistent with the product instructions and manuals.
2. In-home instruction on how to use your product.
3. Repair to correct improper maintenance, installation not in accordance with installation instructions or electrical or plumbing codes, or repair of household electrical or plumbing systems.
4. Consumable parts (e.g., light bulbs, batteries, air or water filters, preservation solutions, etc.).
5. Defects or damage resulting from accident, misuse, abuse, alteration, fire, floods, acts of God or improper installation.
6. Damages, defects, or repairs caused by unauthorized servicers or use of non-genuine or third-party parts.
7. Any damage to the finish of appliance or home incurred during installation, including but not limited to floors, cabinets, walls, etc.
8. Cosmetic damage (e.g., scratches, dents, chips, and other damage to appliance finishes), unless such damage results from defects in materials and workmanship and is reported to W Appliance Co., within 48 hours from date of delivery.
9. If the appearance or exterior of the product has been damaged or defaced, altered or modified in design or construction.
10. Discoloration, rust or oxidation of surfaces resulting from caustic or corrosive environments (e.g., high salt concentrations, high moisture or humidity or exposure to chemicals).
11. Product pick-up or delivery. This warranty is for in-home repair only.
12. Travel or transportation expenses for service in remote locations where an authorized servicer is not available.
13. Products not accessible to provide required service or for expenses making the product accessible for servicing.
14. Surcharges including but not limited to, any after hour, weekend, or holiday service calls, tolls, ferry trip charges, or mileage expenses for service calls to remote areas, including the state of Alaska.
15. Repair, removal or reinstallation of inaccessible appliances or built-in fixtures (e.g., trim, decorative panels, flooring, cabinetry, islands, countertops, drywall) that interfere with servicing, removal or replacement of the product.
16. Appliances with original, factory installed model/serial numbers removed, altered or not easily determined.
17. Incidental or consequential damages (e.g., loss of food or medicine) resulting from appliance breakdown or delay in service, repair or replacement.
18. Transportation and shipping costs associated with the replacement of the unit.
19. Glass parts and other accessory items included with the unit.
20. Products that have been purchased as refurbished, like new, second-hand, under "as is" or "final sale" terms.
21. Units that have been transferred from the original owner/purchaser.
22. If there is damage due to power line surge, user damage to the AC power cord or connection to improper voltage source.
23. Products which are not defective or broken, or which are working as described in the owner's manual.

DISCLAIMER OF IMPLIED WARRANTIES

Repair or replacement as provided under this warranty is the exclusive remedy to the customer. W. Appliance Co. shall not be liable for any incidental or consequential damages for breach of any express or implied warranty on this product, except to the extent prohibited by applicable law. Any implied warranties, including any implied warranty of merchantability or implied warranty of fitness for a particular purpose, are limited to the duration of this warranty or the shortest period allowed by law. Some states do not allow the exclusion or limitations of consequential damages, or limitations on how long the warranty lasts. In these cases, the above exclusions or limitations may not apply to you. This warranty gives you specific legal rights and you may also have other rights which may vary from state to state.

W. Appliance Co. does not warrant that the appliance will work properly in all environmental conditions and makes no warranty and representation, either implied or expressed, with respect to the quality, performance, merchantability, or fitness for a particular purpose other than the purpose identified within this user's manual. W Appliance Co. has made every effort to ensure that this user's manual is accurate and disclaims liability for any inaccuracies or omissions that may have occurred. Information in this user's manual is subject to change without notice and does not represent a commitment on the part of W Appliance Co. W Appliance Co. reserves the right to make improvements to this user's manual and/or to the product described at any time without notice. If you find information in this manual that is incorrect, misleading or incomplete, please call 844-299-0879.

W Appliance Co.
New York, NY 10018

EXTENDED WARRANTY COVERAGE

Protect Your Appliance with Extended Warranty Coverage

Thank you for purchasing your new appliance! Your product comes with our one-year limited warranty, but why stop there? With our Extended Warranty and Accidental Damage Protection Plan, provided by Mulberry, you can ensure your appliances are covered for longer—without worrying about unexpected breakdowns or accidents.

Why Upgrade to the Extended Warranty Plan?

- **Comprehensive Protection** – Extend your warranty coverage and get full protection for accidental damage and mechanical/electrical failures, giving you peace of mind well beyond the first year.
- **No Hidden Costs** – You won't pay any deductibles or service fees for repairs or replacements. We've got you covered!
- **Avoid Expensive Repairs** – Appliances like refrigerators, air conditioners, and dishwashers can be costly to repair. Keep your products running smoothly without the worry of unexpected repair bills.
- **Quick & Easy Claims** – Mulberry offers hassle-free claims and quick, reliable service when you need it most—no complicated paperwork, just fast and efficient help.



Coverage	Basic Warranty	Protection +
Mechanical / Electrical Failure Coverage	Yes (1 year)	Yes (2 - 4 years)
Service Fee or Deductible	Yes (may apply)	No
Parts & Labor Costs Covered	Yes (limited to 1 year)	Yes (2 - 4 years)
Hassle-Free Claims Process	Standard	Priority (faster service)
Repair / Replacement Options	Yes (limited to 1 year)	Yes (2 - 4 years)
Convenience & Peace of Mind	Limited to 1 year	Guaranteed for up to 4 years

BLACK & DECKER, BLACK+DECKER, the BLACK & DECKER and BLACK+DECKER logos and product names and the orange and black color scheme are trademarks of The Black & Decker Corporation, used under license. All rights reserved.

BLACK & DECKER, BLACK+DECKER, y los logos y nombres de productos de BLACK & DECKER y BLACK+DECKER y el esquema de colores naranja y rojo son marcas registradas de The Black & Decker Corporation, usados bajo licencia. Todos los derechos reservados.

BLACK & DECKER, BLACK + DECKER, les logos et noms de produits BLACK & DECKER et BLACK + DECKER, ainsi que la palette de couleurs orange et noir sont des marques de commerce de The Black & Decker Corporation, utilisées sous licence. Tout droit réservé.

Product in this box may differ slightly from that pictured. Does not affect function. Not all accessories shown in photography are included in this package.

El producto en esta caja puede diferir ligeramente del representado en las imágenes. Esto no afecta su función. No todos los accesorios mostrados en las fotografías son incluidos en este paquete.

Le produit dans cette boîte peut différer légèrement de celui illustré. N'affecte pas la fonction. Pas tous les accessoires présentés dans la photographie sont inclus dans ce paquet.

Imported by W Appliance, Inc., 1356 Broadway, New York, NY 10018
Customer Service: 844-299-0879

Importado por W Appliance, Inc., 1356 Broadway, New York, NY 10018
Servicio al Cliente: 844-299-0879

Importé par W Appliance, Inc., 1356 Broadway, New York, NY 10018
Service À La Clientèle: 844-299-0879