

BLACK+[®] DECKER

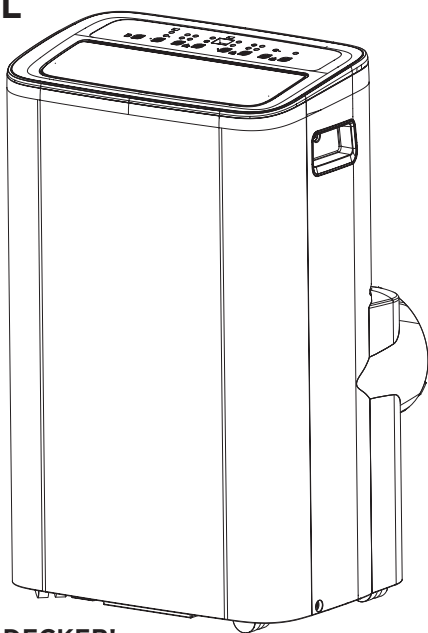

SMART PORTABLE AIR CONDITIONER - INVERTER TECHNOLOGY INSTRUCTION MANUAL

CATALOG NUMBER
BPACT08NM



Thank you for choosing BLACK+DECKER!

PLEASE READ BEFORE RETURNING THIS PRODUCT FOR ANY REASON.

If you have a question or experience a problem with your BLACK+DECKER purchase, go to www.blackanddecker.com/instantanswers

If you can't find the answer or do not have access to the Internet, call 844-299-0879 from 10:30 a.m. to 6:30 p.m. EST Mon. - Fri. to speak with an agent. Please have the catalog number available when you call.

SAVE THIS MANUAL FOR FUTURE REFERENCE.

CONTENTS

SAFETY INFORMATION

Important Safety Instructions.....	3-4
Grounding Instructions.....	5
LCDI Power Cord and Plug.....	6
Safety Guidelines.....	7-10
Operation Condition.....	11

SET UP & USE

Parts & Features	12
Installation Guide	13
Window Slider Kit Installation	14
Double-Hung Sash/Sliding Casement Window Installation.....	14
Exhaust Hose Installation.....	15-16
Control Panel.....	17
Operating from the Control Panel.....	17-19
Downloading the App and Operating with Wi-Fi.....	20-27
Connection Methods.....	28
Connecting to the Appliance	29-32
Controlling the Portable Air Conditioner with the APP.....	33-35
Voice control device settings.....	36-37
Set Up Voice Control with ALEXA.....	38-41
Set Up Voice Control with GOOGLE Assistant.....	42-45
Operating from the Remote Control.....	46-48
Water Drainage Method for Cool Mode	49-50

CLEANING & CARE.....	51
----------------------	----

TROUBLESHOOTING & WARRANTY

Before You Call for Service	52
Customer Service.....	52
Troubleshooting.....	53-55
Limited Warranty.....	56

PRODUCT REGISTRATION

Thank you for purchasing our BLACK+DECKER product. This easy-to-use manual will guide you in getting the best use of your product.

Remember to record the model and serial numbers. They are on a label on the back of the product.

Staple your receipt to your manual. You will need it to obtain warranty service.

Model number

Serial number

Date of purchase

SAFETY INFORMATION



DANGER

DANGER - Immediate hazards which **WILL** result in severe personal injury or death



WARNING

WARNING - Hazards or unsafe practices which **COULD** result in severe personal injury or death



CAUTION

CAUTION - Hazards or unsafe practices which **COULD** result in minor personal injury

IMPORTANT SAFETY INSTRUCTIONS



WARNING

When using electrical appliances, basic safety precautions should be followed, including the following:

1. To reduce risk of injury, read this guide before using the appliance.
2. The air conditioner must be connected to the correct electrical outlet and electrical supply.
3. Proper grounding must be ensured to reduce the risk of shock and fire. **DO NOT CUT OR REMOVE THE GROUNDING PRONG.** If you do not have a three-prong electric receptacle outlet in the wall, have a certified electrician install the proper receptacle. The wall receptacle **MUST** be properly grounded.
4. Do not operate air conditioner if power cord is frayed or otherwise damaged. Avoid using it if there are any cracks or abrasion damage along the length, plug connector or if the unit malfunctions or is damaged in any manner. Contact an authorized service technician for examination, repairs or adjustments.
5. **DO NOT USE AN ADAPTER OR AN EXTENSION CORD.**
6. Do not block airflow around the air conditioner. The exhaust hose should be free of any obstructions.
7. Always unplug the air conditioner before servicing it or moving it.
8. Do not install or use the air conditioner in any area where the atmosphere contains combustible gases or where the atmosphere is oily or sulphurous. Avoid any chemical coming in contact with your air conditioner.
9. Do not place any object on the top of the unit.
10. Never operate the air conditioner without filters in place.
11. Do not use the air conditioner near a bathtub, shower or wash basin.
12. This appliance is not intended for use by persons (including children) with reduced physical sensory or mental capabilities or lack of experience & knowledge, unless they have been given supervision or instruction concerning use of the appliance by a person responsible for their safety.
13. Children should be supervised to ensure that they do not play with the appliance.
14. If the **SUPPLY CORD** is damaged, it must be replaced by the manufacturer, a service agent or similarly qualified persons in order to avoid a hazard.
15. The air conditioner shall be installed in accordance with national wiring regulations.



Caution, risk of fire



SAFETY INFORMATION

HANDLING ALKALINE BATTERIES

WARNING

When handling alkaline batteries, basic safety precautions should be followed, including the following:

1. Should fluid from the battery accidentally get into your eyes, there is a threat of loss of eyesight, do not rub them. Immediately rinse your eyes with clean tap water and then consult a physician immediately.
2. Do not put the battery in a fire, expose it to heat, dismantle or modify it. If the insulation or safety valve is damaged, the battery may leak fluid, overheat or explode.
3. Do not insert the battery with the polarities reversed. Doing so may cause some abnormality or a short and the battery may leak fluid, overheat or explode.
4. Keep the battery out of the reach of children. If the battery is swallowed, contact a physician immediately.
5. If the alkali fluid gets in your mouth, rinse your mouth with water and contact a physician immediately.
6. If the alkali fluid gets on your skin or clothes, it may burn your skin, thoroughly rinse the affected area with tap water.
7. Do not mix new and old batteries or other makes of batteries. The different attributes may cause the battery to leak fluid, overheat or explode.
8. This battery was not made to be recharged. Recharging this battery may damage the insulation or internal structure and may cause the battery to leak fluid, overheat or explode.
9. Do not damage or remove the label on the exterior of the battery. Doing so may cause the battery to short, leak fluid, overheat or explode.
10. Do not drop, throw or expose the battery to extreme impact. Doing so may cause the battery to leak fluid, overheat or explode.
11. Do not alter the shape of the battery. If the insulation or safety valve is damaged, the battery may leak fluid, overheat or explode.
12. Immediately remove batteries when they have lost all power. Leaving the batteries in the unit for a long time may cause the batteries to leak fluid, overheat or explode due to gas that is generated by the batteries.
13. Remove the batteries from the unit when not using the unit for an extended period of time. The batteries may leak fluid, overheat or explode due to gas that is generated by the batteries.
14. Do not apply solder directly to the batteries. The heat may cause the batteries to leak fluid, overheat or explode.
15. Do not get the batteries wet. Doing so may cause the batteries to overheat.
16. Store batteries someplace out of direct sunlight where the temperature and humidity are not high. Not doing so may cause the batteries to leak fluid, overheat or explode. Also, it may cause the life and performance of the batteries to decline.
17. Follow the regulations of the local government when disposing of these batteries.
18. NEVER mix alkaline, standard (carbon-zinc), rechargeable (nickel-cadmium) batteries with this product.

SAVE THESE INSTRUCTIONS

HOUSEHOLD USE ONLY

SAFETY INFORMATION

GROUNDING INSTRUCTIONS

ELECTRICAL REQUIREMENTS

In the event of malfunction or breakdown, grounding provides a path of least resistance for electric current to reduce the risk of electric shock. The appliance must be connected to a cord having an equipment-grounding conductor and a grounding plug. The plug must be plugged into an appropriate outlet that is properly installed and grounded in accordance with all local codes and ordinances.

⚠ DANGER - Improper connection of the equipment grounding conductor can result in a risk of electric shock. The conductor with insulation having an outer surface that is green with or without yellow stripes is the equipment grounding conductor. If repair or replacement of the cord or plug is necessary, do not connect the equipment-grounding conductor to a live terminal. Check with a qualified electrician or service person if the grounding instructions are not completely understood, or if in doubt as to whether the appliance is properly grounded. Do not modify the plug connected to the appliance - if it will not fit the outlet, have a proper outlet installed by a qualified electrician.

FOR GROUNDED, CORD-CONNECTED APPLIANCE RATED LESS THAN 15A AND INTENDED FOR USE ON A NOMINAL 120V SUPPLY CIRCUIT

The appliance is for use on a nominal 120V circuit and should be connected to a grounding outlet that looks like the one illustrated below. The use of a temporary adapter is not recommended.

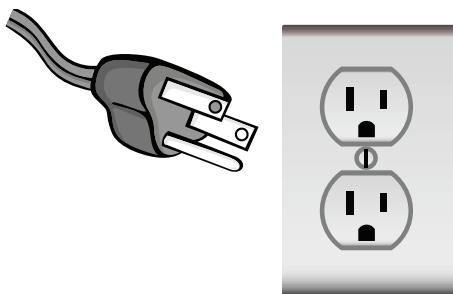

SAFETY INFORMATION

LCDI POWER CORD AND PLUG

This air conditioner is equipped with an LCDI (Leakage Current Detection and Interruption) power cord that is required by UL. This power supply cord contains state-of-the-art electronics that sense leakage current. If the cord is damaged and leakage occurs, power will be disconnected from the unit.

The test and reset buttons on the LCDI Plug are used to check if the plug is functioning properly.

⚠ WARNING: Test LCDI before each use.

To test the plug:

1. Plug power cord into a grounded 3-prong outlet.
2. Press RESET (on some units a green light will turn on).
3. Press the TEST button, the circuit should trip and cut all power to the air conditioner (on some units green light may turn off).
4. Press the RESET button for use. You will hear a click and the A/C is ready for use.
5. The power supply cord must be replaced if it fails to trip when the TEST button is pressed and the unit fails to reset.

NOTE:

- Do not use this device to turn the unit on or off.
- Always make sure the reset button is pushed in for correct operation.

⚠ WARNING:

- The power supply cord must be replaced if it fails to reset when either the test button is pushed, or it cannot be reset.
- If power supply cord is damaged, it can not be repaired.
- It must be replaced by one obtained from the product manufacturer.

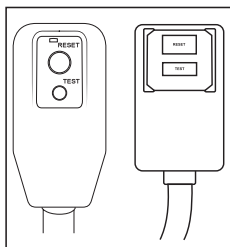

⚠ WARNING - RISK OF FIRE

- It is important the plug fits tightly into the wall outlet.
- If the plug does not fit securely and appears loose, it should not be used.
- Have a licensed electrician replace the receptacle.

SAFETY INFORMATION

SAFETY GUIDELINES

⚠ WARNING: To prevent injury to the user or other people and property damage, the following instructions must be followed. Incorrect operation due to ignoring of instructions may cause harm or damage.

ALWAYS DO THIS	NEVER DO THIS	ENERGY SAVE
<ul style="list-style-type: none">• Your air conditioner should be used in such away that it is protected from moisture. e.g. condensation, splashed water, etc. Do not place or store your air conditioner where it can fall or be pulled into water or any other liquid. Unplug immediately.• Always transport your air conditioner in a vertical position and stand on a stable, level surface during use.• Turn on the product when not in use.• Always use the switch on the control panel to start or shut off the unit.• Always contact a qualified person to carry out repairs. If the supply cord is damaged it must be repaired by a qualified technician.• Keep an air path of at least 12 inches all around the unit from walls, furniture and curtains.• If the air conditioner is knocked over during use, turn off the unit and unplug from the power supply immediately.	<ul style="list-style-type: none">• Do not operate your air conditioner in a wet room such as a bathroom or laundry room.• Do not touch the unit with wet or damp hands or when barefoot. Do not press the buttons on the control panel with anything other than your fingers.• Do not remove any fixed covers. Never use this appliance if it is not working properly, or if it has been dropped or damaged.• Never use the plug to start and stop the unit.• Do not cover or obstruct the inlet or outlet grilles.• Do not use hazardous chemicals to clean or come into contact with the unit. Do not use the unit in the presence of flammable substances or vapor such as alcohol, insecticides, gasoline etc.• Do not allow children to operate the unit unsupervised.• Do not use this product for functions other than those described in this instruction manual.	<ul style="list-style-type: none">• Locate the unit where furniture cannot obstruct the air flow.• Keep blinds / curtains drawn.• Keep the filters clean.• Keep doors and windows closed to keep cool air in and warm air out.

SAFETY INFORMATION

IMPORTANT SAFEGUARD

WARNING:

- This hermetically sealed system contains fluorinated greenhouse gases.
ENVIRONMENTAL INFORMATION: This unit contains fluoridated greenhouse gases covered by the Kyoto Protocol.
- Do not use this unit for functions other than those described in this instruction manual.
- Make sure the plug is plugged firmly and completely into the outlet. It can result in the risk of electric shock or fire.
- Do not plug other appliances into the same outlet, it can result in the risk of electric shock.
- Do not disassemble or modify the appliance or the power cord, it can result in the risk of electric shock or fire. All other services should be referred to a qualified technician.
- Do not place the power cord or appliance near a heater, radiator, or other heat source. It can result in the risk of electric shock or fire.
- This unit is equipped with a cord that has an earthed wire connected to an earthed pin or grounding tab. The plug must be plugged into a socket that is properly installed and earthed. Do not under any circumstances cut or remove the earthed pin or grounding tab from this plug.
- The unit should be used or store in such a way that it is protected from moisture e.g. condensation, splashed water, etc. Unplug unit immediately if this occurs.
- Always transport your appliance in a vertical position and place on a stable, level surface during use. If the unit is transported laying on its side it should be stood up and left unplugged for 6 hours.
- Always use the switch on the control panel or remote controller to turn the unit off, and do not start or stop operation by plugging in or unplugging the power cord. It can result in the risk of electric shock.
- Do not touch the buttons on the control panel with your wet and damp fingers.
- Do not use hazardous chemicals to clean or come into contact with the unit. To prevent damage to the surface finish, use only a soft cloth to clean the appliance, Do not use wax, thinner, or a strong detergent. Do not use the unit in the presence of inflammable substance or vapor such as alcohol, insecticides, gasoline, etc.
- If the appliance is making unusual sounds or is emitting smoke or an unusual odor, unplug it immediately.
- Do not clean the unit with water. Water can enter the unit and damage the insulation, creating a shock hazard. If water enters the unit, unplug it immediately and contact Customer Service.
- Utilize two or more people to lift and install the unit.
- Always grasp the plug when plugging in or unplugging the appliance. Never unplug by pulling on the cord. It can result in the risk of electrical shock and damage.
- Install the appliance on a sturdy, level floor capable of supporting up to 110 lbs (50kg). Installation on a weak or unlevel floor can result in the risk of property damage and personal injury.

ELECTRICAL CONNECTIONS

Before plugging the appliance into the mains socket, check that:

- The mains power supply corresponds to the value indicated on the rating plate on the back of the appliance.
- The power socket and electrical circuit are adequate for the appliance.
- The mains socket matches the plug. If this is not the case, have the plug replaced.
- The mains socket is adequately earthed. Failure to follow these important safety instructions absolves the manufacturer of all liability.

SAFETY INFORMATION

WARNING:

- This appliance is not intended for use by persons (including children) with reduced physical, sensory or mental capabilities, or lack of experience and knowledge, unless they have been given supervision or instruction concerning use of the appliance by a person responsible for their safety.
- Children should be supervised to ensure that they do not play with the appliance.
- If the SUPPLY CORD is damaged, it must be replaced by the manufacturer, its service agent or similarly qualified persons in order to avoid a hazard.
- The appliance shall be installed in accordance with national wiring regulations.
- Do not use means to accelerate the defrosting process or to clean, other than those recommended by the manufacturer.
- The appliance shall be stored in a room without continuously operating ignition sources (for example open flames, an operating gas appliance or an operating electric heater).
- Do not pierce or burn.
- Be aware that refrigerants may not contain an odor.

WARNING:

- The handling, installation, storage, servicing and disposal must comply with the provisions of gas-related national laws and regulations, and also national wiring regulation.
- It is necessary to clear away the refrigerant in the system when maintaining or scrapping an appliance.
- Ventilated area (open doors and Windows)
Ensure that the working area is open or well ventilated before turning on the system or performing hot work. Ventilation should be maintained during operation. Ventilation quickly displaces safely diluted leaked refrigerant into the atmosphere.
- Flammable refrigerant R32/R290 is used within appliance. Please follow the instructions carefully to handle, install, clean, and service the appliance to avoid damage or hazard. Do not dispose of appliance in regular trash. Contact qualified agency for proper disposal.
- Servicing shall be performed only as recommended by the manufacturer.



SAFETY INFORMATION



FCC Caution

This device complies with part 15 of the FCC Rules. Operation is subject to the following two conditions:

(1) This device may not cause harmful interference, and (2) this device must accept any interference received, including interference that may cause undesired operation. Any changes or modifications not expressly approved by the party responsible for compliance could void the user's authority to operate the equipment.

NOTE: This equipment has been tested and found to comply with the limits for a Class B digital device, pursuant to part 15 of the FCC Rules. These limits are designed to provide reasonable protection against harmful interference in a residential installation. This equipment generates uses and can radiate radio frequency energy and, if not installed and used in accordance with the instructions, may cause harmful interference to radio communications. However, there is no guarantee that interference will not occur in a particular installation. This equipment does cause harmful interference to radio or television reception, which can be determined by turning the equipment off and on, the user is encouraged to try to correct the interference by one or more of the following measures:

- Reorient or relocate the receiving antenna.
- Increase the separation between the equipment and receiver.
- Connect the equipment into an outlet on a circuit different from that which the receiver is connected.
- Consult the dealer or an experienced radio/TV technician for help. The distance between user and device should be no less than 20cm.

IC Warning

This device complies with industry Canada's licence-exempt RSSs. Operation is subject to the following two conditions:

1. This device may not cause interference; and
2. This device must accept any interference, including interference that may cause undesired operation of the device.

This equipment complies with FCC radiation exposure limits set forth for an uncontrolled environment. This equipment should be installed and operated with minimum distance 20cm between the radiator & your body.

SAFETY INFORMATION

OPERATION CONDITION

The air conditioner must be operated within the temperature range indicated below:

NOTE: Unit performance may be affected when in use outside of these operating temperatures.

MODE	ROOM TEMPERATURE
COOL	60°F (16 °C)-95°F (35 °C)
DEHUMIDIFYING (DRY)	55°F (13 °C)-95°F (35 °C)

The air conditioner should be operated in the relative humidity range of 30%-90% RH.

Never Transport or turn the appliance upside down or on its side. If this occurs wait at least 6 hours before turning the appliance on 24 hours is recommended. After the unit has been on its side, oil needs to return to the compressor to ensure proper function. Without allowing 6-24 hours before turning on, the unit may function for only a short time, and then the compressor will break down from lack of oil.

SET UP & USE

PARTS & FEATURES

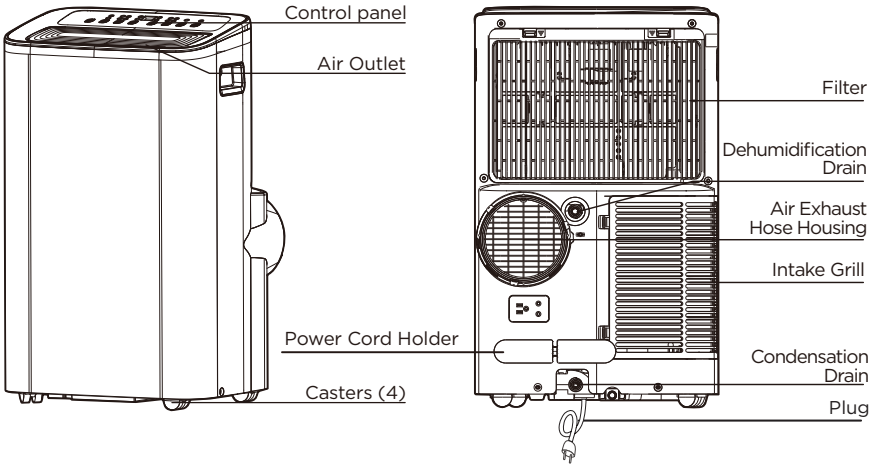

Hose inlet

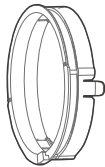

Air Exhaust Hose



Hose Outlet

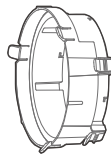

Drain Hose (23.75" Long)



Window Slider



A



B

Bolt



Security Bracket
+ 2 screws



Adhesive
Foam Seal



Adhesive
Foam Strips



Foam Seal
Non-Adhesive

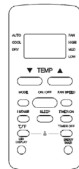

Remote
Control

INSTALLATION GUIDE

LOCATION

- The air conditioner should be placed on a firm floor to minimize noise and vibration. For safe and secure positioning, place the unit on a smooth, level floor strong enough to support the unit.
- The unit has casters to aid placement, but it should be rolled on smooth, flat surfaces. Use caution when rolling on carpet surfaces. Do not attempt to roll the unit over objects.
- The unit must be placed within reach of a properly rated grounded socket.
- Never place any obstacles around the air inlet or outlet of the unit.
- It is recommended to allow at least 31.5 inches of clearance between the sides of the portable air conditioner and at least 19.7 inches of space between the top of the portable air conditioner and any adjacent obstacles for optimal air flow.

SUGGESTED TOOLS FOR WINDOW KIT INSTALLATION

- Screwdrivers (medium size Phillips)
- Tape measure or ruler
- Knife or scissors
- Saw (In the event that the window kit needs to be cutdown in size because the window is too narrow for direct installation)

SET UP & USE

WINDOW SLIDER KIT INSTALLATION

Your window slider kit has been designed to fit most standard “Vertical” and “Horizontal” window applications; however, it may be necessary for you to improvise/modify some aspect of the installation procedures for certain types of window.

WINDOW OPENING:

MAXIMUM: 48” (121.92 cm)

NOTE: A bolt is provided to secure the 2 window slider panels. Adjust the slider to fit the window and insert the bolt in a hole on the side of the slider as shown to secure it.

NOTE: If the window opening is less than 26.5” the minimum length of the window slider kit, cut the trim panel B (labeled) to fit for the window opening. Make sure to trim the panel “B”. Never cut out the hole in window slider kit.

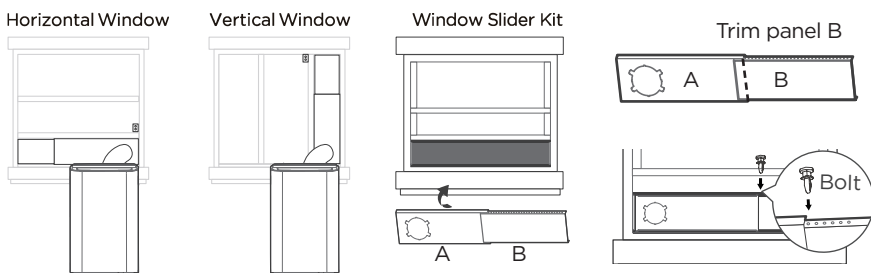

DOUBLE-HUNG SASH/SLIDING CASEMENT WINDOW INSTALLATION

1. Cut the foam seal (adhesive type) to the proper length and attach it to the window sash.
2. Attach the window slider kit to the window sash. Adjust the length of the window slider kit according to the width of window. Shorten the adjustable window kit if the width of window is less than 26.5”.
3. Cut the foam strips (adhesive type) to the proper length and attach it on the top of the window.
4. Close the window securely against the window slider kit.
5. Secure the window slider kit to the window sash.
6. Cut the non-adhesive foam seal to an appropriate length and seal the open gap between the top window frame and outer window frame.

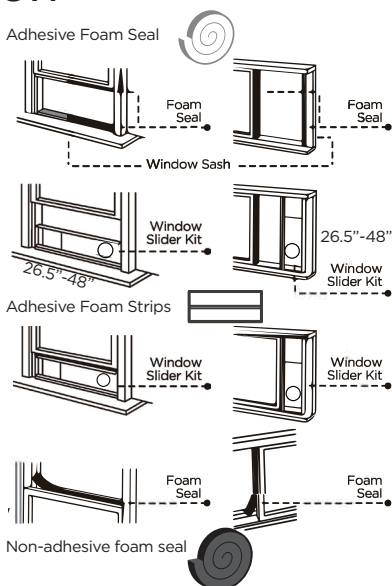

SET UP & USE

EXHAUST HOSE INSTALLATION

The air exhaust hose and hose inlet must be installed or removed from the portable air conditioner in accordance with the way it is being used:

COOL, AUTO, DRY Air exhaust hose and hose inlet should be connected to the portable air conditioner.

FAN: Air exhaust hose and hose inlet should be disconnected from the portable air conditioner.

To Install:

Position the unit on a flat level surface and make sure there is a minimum clearance of 18" (45cm) and is located near a single circuit power outlet.

1. Align the slots of the hose inlet with the tabs on the exhaust hose and push together to insert. Fig. 1
2. Align the slots of the hose outlet with the tabs on the exhaust hose and push together to insert. Fig. 2
3. Install the inlet side of the assembled hose with the slots on the back of the unit. Fig. 3

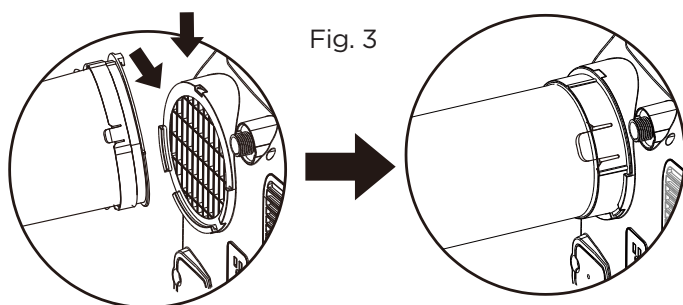
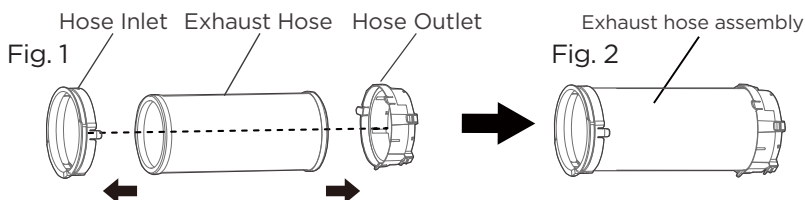

NOTE: The exhaust hose can be compressed or extended moderately, but it is desirable to keep the length to a minimum. Also make sure that the hose does not have any sharp bends.



SET UP & USE

4. Insert the hose outlet into the hole of the slider.

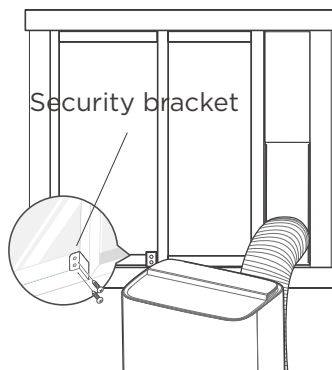
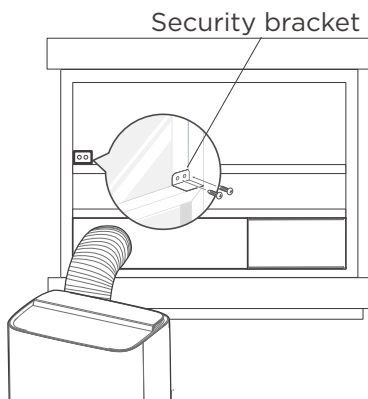

OPTIONAL.: After the window slider is installed, the supplied security bracket with 2 screws can be used to secure it. Install as shown.

SET UP & USE

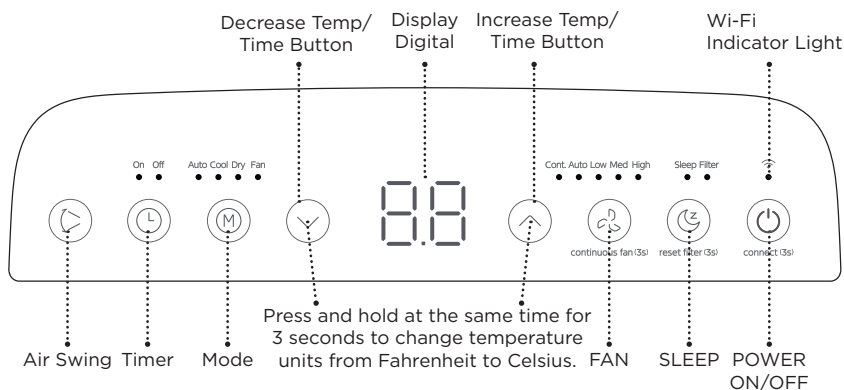

CONTROL PANEL

NOTE: To mute the sound when settings are changed =, press “Display” on the remote. This function is only available on the remote.



OPERATING FROM THE CONTROL PANEL

TURNING THE APPLIANCE ON

- Plug into the dedicated electrical outlet.
- Press the  button to turn the appliance on. Press it again to shut it off. The last function active when it was turned off will appear.
- Never turn the air conditioner off by unplugging from the outlet. Always press the  button, then wait for a few minutes before unplugging. This allows the appliance to perform a cycle of checks to verify operation.

NOTE: Before pressing Power On button make sure the condensate drain cap in the rear of the unit is securely in place to avoid any leaking.

- Press the MODE  button until the light corresponding to the required Mode lights up.



SET UP & USE

COOL MODE

Ideal for hot weather when you need to cool the room. To set operation of the appliance correctly, press the **▲** or **▼** buttons to select a temperature between 60°F-86°F (16°C-30°C). The selected temperature will be indicated on the digital display. Select the fan speed by pressing the Fan Speed Button until the light corresponding to the required fan speed illuminates:



HIGH: The Fan operates at maximum to reach the required temperature as rapidly as possible.

MED: Reduces Fan noise level but still maintains a good level of comfort.

LOW: For quiet operation.

AUTO: The appliance automatically selects the most suitable fan speed in relation to the temperature set on the digital display.

DRY MODE

DRY mode is perfect for dehumidifying humid or damp rooms. To activate DRY mode, press the MODE button until the DRY indicator light illuminates.

The AUTO fan light will turn on.

Temperature and speeds are not adjustable in this mode.

Ensure the exhaust hose is attached to enable external air discharge.

The dehumidifier will need to be drained. See CONTINUOUS DRAINING FOR DRY MODE.

When the water level of dehumidifier reaches a predetermined level, the unit beeps 8 times, and the digital display shows "P1". The unit will shut off when the internal water tank is full.

AUTO MODE

In AUTO mode the unit automatically controls the cooling or fan only operation depending on the selected set temperature and the room temperature. Press the up /down buttons until the target temperature is displayed. When AUTO mode is selected the indicator light illuminates.

NOTE: The fan speed cannot be selected in AUTO mode.

FAN MODE

Press the fan button repeatedly to scroll through, AUTO, LOW, MEDIUM and HIGH settings.

In Cool and Dry modes, press and hold the fan button for 3 seconds to activate the Continuous Fan function, ensuring a steady fan speed that won't shut off once the set temperature is reached. The corresponding Cont. light will illuminate. Press and hold the fan button for another 3 seconds to deactivate this function.



NOTE: The temperature cannot be selected in fan mode.

SET UP & USE

SETTING THE TIMER



This timer can be used to delay the appliance start-up or Shut down, from 30 minutes to 24 hours, in AUTO, COOL or DRY modes.

Programming Auto ON

With the air conditioner turned OFF, press the TIMER button. The corresponding timer ON indicator light will show that the timer is activated. Use the  or  buttons.

to set the number of hours to delay start up. The amount of hours set will appear on the digital display.

Programming Auto OFF

With the air conditioner turned ON, press the TIMER button. The Corresponding timer ON indicator light will show that the timer is activated. Use the  or  buttons.

The amount of hours set will appear on the digital display.

To cancel the Timer settings press the Timer button again. The corresponding Timer OFF indicator light will illuminate.

NOTE: If the time is not selected within a few seconds of pressing the timer button, the digital display will show the temperature. Press the timer button to resume setting the time.

AUTO AIR SWING

Press the AIR SWING button to activate the louver panel to swing up and down, Press again to deactivate.

SLEEP:

The SLEEP function is used to gradually decrease energy use while you sleep and don't need the same temperature settings to stay comfortable. The SLEEP function is available in COOL mode.

Press the SLEEP button when you are ready to go to sleep.

When in COOL mode, the unit will increase the temperature by 2°F (1°C) after 30 minutes, and will increase an additional 2°F (1°C) after another 30 minutes.

The sleep feature will maintain this temperature for 7 hours before returning to the original set temperature.

FILTER

The filter indicator light will illuminate after 250 hours of operation. Clean the filter. To reset after cleaning the filter, press and hold the SLEEP button for 3 seconds and the light will go off.

Wi-Fi Indicator Light.

This light indicates the status of the Wi-Fi connection. The indicator light will blink while in pairing. It will be steady once a successful connection is made.

SET UP & USE

DOWNLOADING THE APP AND OPERATING WITH Wi-Fi

Operation Steps	Operation Items	New Account	Re-install APP (registered before)
Step 1	Download and Install APP	YES	YES
Step 2	Registration Account	YES	NO
Step 3	Login	YES	YES
Step 4	Add Device to control	YES	Registered Device will remain.

FCC CAUTION

- This device complies with part 15 of the FCC Rules. Operation is subject to the following two conditions: (1) This device may not cause harmful interference, and (2) this device must accept any interference received, including interference that may cause undesired operation.
- Any Changes or modifications not expressly approved by the party responsible for compliance could void the user's authority to operate the equipment.

NOTE: This equipment has been tested and found to comply with the limits for a Class B digital device, pursuant to part 15 of the FCC Rules. These limits are designed to provide reasonable protection against harmful interference in a residential installation. This equipment generates, uses and can radiate radio frequency energy and, if not installed and used in accordance with the instructions, may cause harmful interference to radio communications. However, there is no guarantee that interference will not occur in a particular installation. If this equipment does cause harmful interference to radio or television reception, which can be determined by turning the equipment off and on, the user is encouraged to try to correct the interference by one or more of the following measures:

- Reorient or relocate the receiving antenna.
- Increase the separation between the equipment and receiver.
- Connect the equipment into an outlet on a circuit different from that to which the receiver is connected.
- Consult the dealer or an experienced radio/TV technician for help. The distance between user and device should be no less than 7.87" (20 cm) .
- If the appliance has the Wi-Fi function, the transmission power: less than 20dBm, and the radio frequency range is: 2412MHz - 2472MHz.

SET UP & USE

Wi-Fi MODULE SPECIFICATION AND BASIC INFORMATION

1. Minimum specifications on a Smart phone:

Android 5.0 version or higher

IOS 10.0 version or higher

2. Basic parameters for Wi-Fi:

Parameters	Details
Network frequency	2.400 - 2.500GHz
Standards of WLAN	IEEE 802.11 b/g/n(channels 1-14)
Protocol stack support	IPv4/IPv6/TCP/UDP/HTTPS/ TLS/Multicast DNS
Security support	WEP/WPA/WPA2/AES128
Network type support	STA/AP/STA+AP

DOWNLOAD AND INSTALL THE APP

Option 1: Scan the QR code with the camera APP from a smartphone. Download and install the APP.

Option 2: For Android smart phone, open the Google "Play Store" on your smart phone and search "BLACK+DECKER Home", download and install the APP.

For IOS smart phone, open the Apple "APP STORE" on your smart phone and search "BLACK+DECKER Home", download and install the APP.



NOTE: Updates to the APP design may occur. This manual is for reference. Follow prompts in the APP.

SET UP & USE

Wi-Fi CONNECTION METHODS

1. If you don't have an account please tap button "Sign Up".
2. Read the Privacy Policy and tap "Agree".

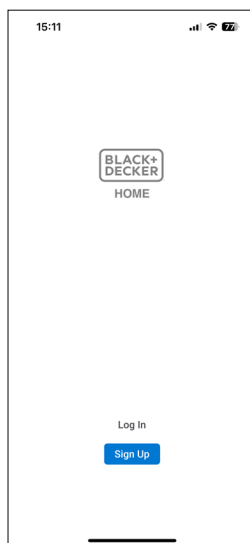
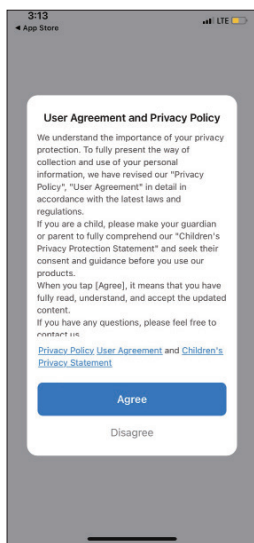

3. Tap "▼" and choose the country.

Scroll to choose the country.

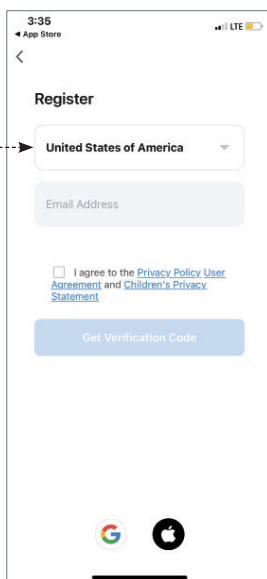

SET UP & USE

4. Enter your E-mail address.
5. Tap the button “Get verification code”.

A screenshot of the 'Register' screen in the App Store. At the top, the status bar shows 3:35, LTE, and battery level. Below the 'Register' title, there is a dropdown menu set to 'United States of America', an 'Email Address' input field, and a checkbox for 'I agree to the Privacy Policy User Agreement and Children's Privacy Statement'. A blue 'Get Verification Code' button is at the bottom. The Google and Apple logos are at the very bottom.

6. Enter the verification code you received from E-mail.
7. Set the password with 6-20 characters including characters and numbers.
8. Tap “Done”.

A screenshot of the 'Enter Verification Code' screen. It shows a title bar with 'Enter Verification Code' and a back arrow. Below the title, there are four empty boxes for entering the code. A message states 'A verification code has been sent to your email. Resend (57s)'. A link 'Didn't get a code?' is below the message. At the bottom is a numeric keypad with letters for letters and a backspace icon.

A screenshot of the 'Set Password' screen. It shows a title bar with 'Set Password' and a back arrow. Below the title, there is a password input field with a strength indicator and a 'Done' button. At the bottom is a standard iOS keyboard with a 'Done' button.

SET UP & USE

LOG IN

1. If you already have account, tap **“Log In”**.
2. Enter your registered account and password.
3. Tap **“Log In”** button.

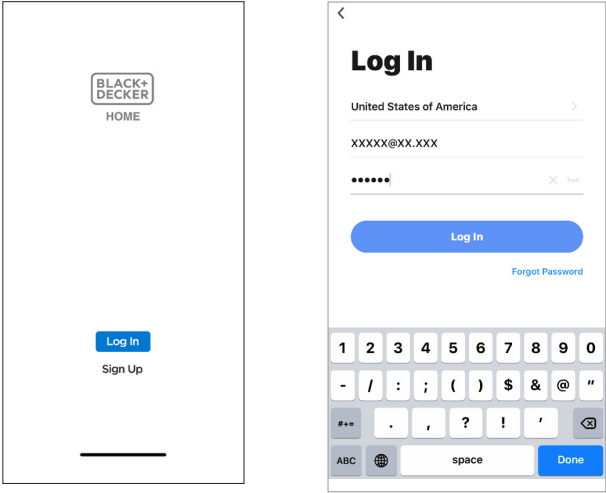

RESETTING THE PASSWORD

If you forgot the password or you want to reset the password, operate as below:

1. Tap **“Forgot Password”**.
2. Enter your account (E-mail address) and tap button **“Get Verification Code”**.
3. Enter the verification code received by your E-mail.
4. Set the new password and tap button **“Done”**.

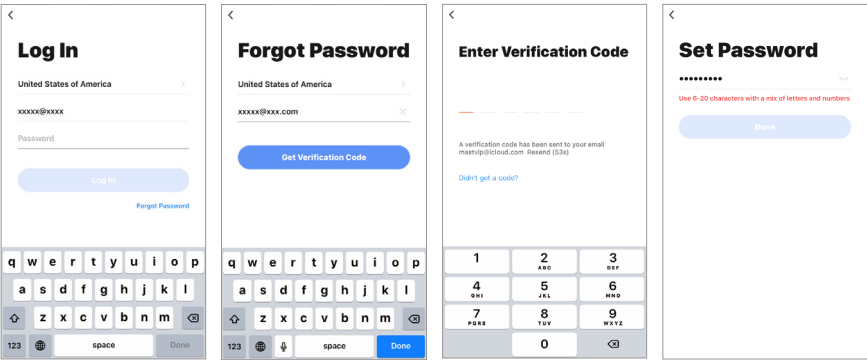

1.

2.

3.

4.

SET UP & USE

ENABLE LOCATION SETTINGS

1. Once logged into the app, ensure that Bluetooth is enabled on your phone and that permissions are enabled.

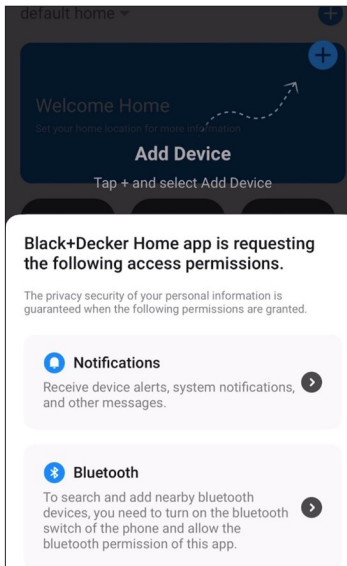

2. Tap on "Add Device" located in the top right corner of the screen.

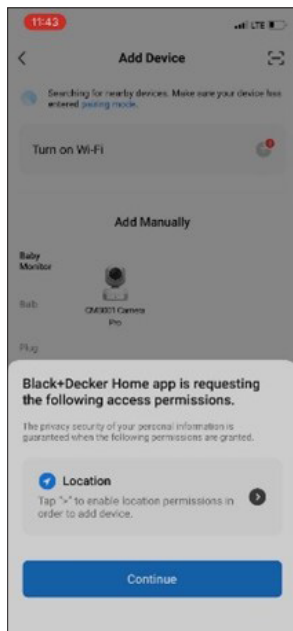
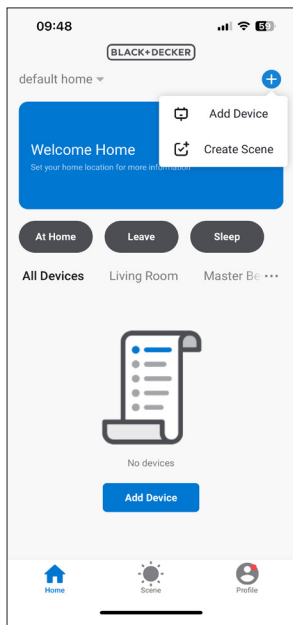

SET UP & USE

3. When location services are enabled, tap on "Set Now".

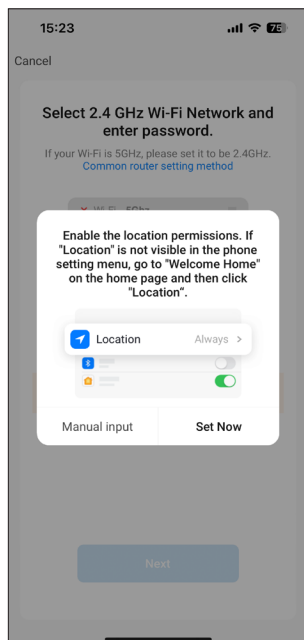

4. If there is difficulty connecting to the app automatically, please ensure that location services on your phone are turned "on" or "enabled".

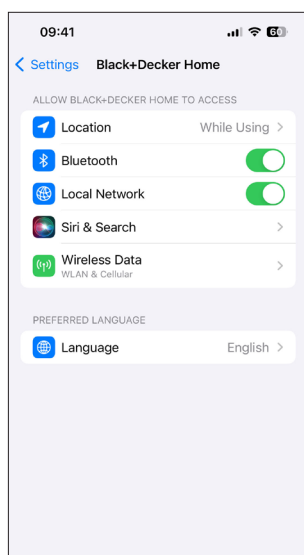

SET UP & USE

5. **Location settings:** Enable location services by accessing the Welcome Home Screen within the app. On the Welcome Home Screen, tap on "Location" and manually enter your current location.
6. Follow the prompts to set up family member management, which allows different profiles to control appliances according to their preferences.
7. Use the "Rooms" feature to organize multiple appliances by room.

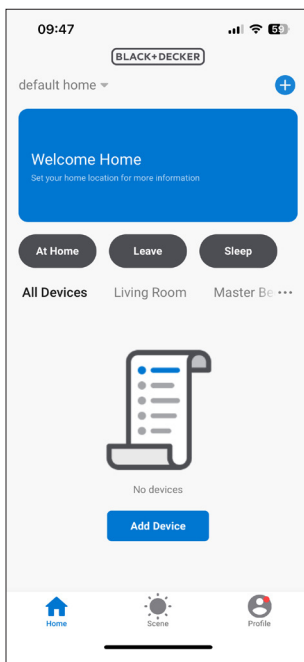
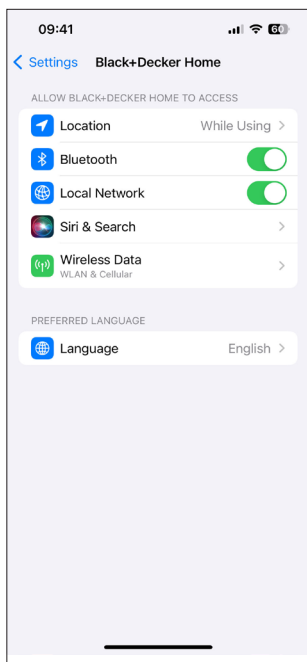

SET UP & USE

CONNECTION METHODS

When Bluetooth is enabled, the APP will automatically search for the device.

If the APP cannot locate the device automatically, follow the instructions and on screen prompts to connect.

Please make sure the appliance is plugged into a wall outlet. It can remain in standby mode or be powered ON to connect to the APP.

Tap “Add Device” or tap “+” in the upper right corner of the “Home” screen and select “Add device”.

When Bluetooth and Location are enabled, the APP will automatically search for the device. If the APP locates the device, it will appear on the screen under “Discovering Devices”.

Tap “Add”

NOTE: If the APP does not discover the device automatically, follow the steps to connect.

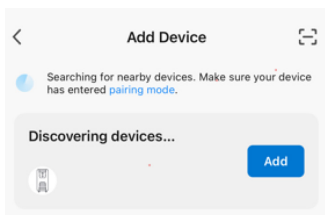

Input the Wi-Fi name and password when prompted, then tap “Next”.

Wait for the appliance to connect. This may take several seconds.

Once connected, the Portable Air Conditioner can be controlled by the APP.

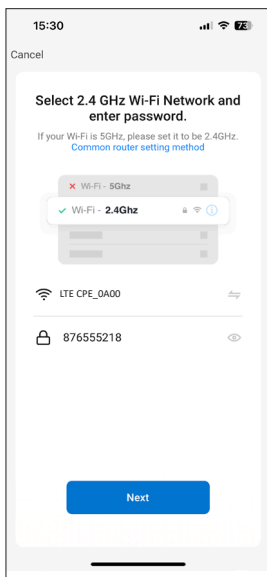

SET UP & USE

CONNECTING TO THE APPLIANCE

1. Click "+" in the upper right corner of the "Home" screen and select "Add device".

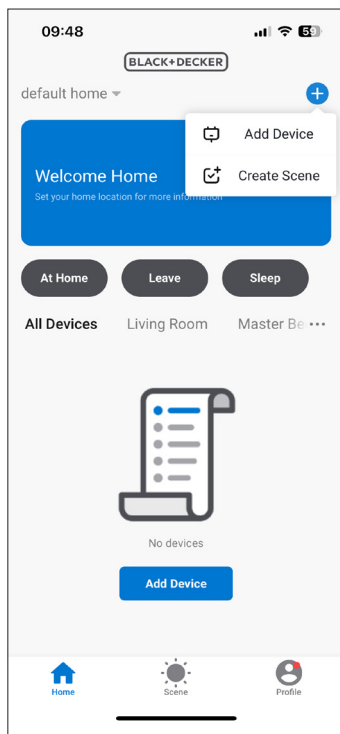

SET UP & USE

2. Tap “Home Appliances”.

3. Tap the Portable AC symbol with the air conditioner’s model number: BPACT08NM. The model number can be located on the front of this user manual and on the rating label of the appliance.

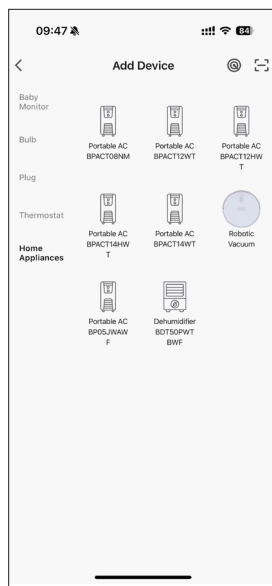

4. Input the Wi-Fi name and password when prompted, then tap “Next”.

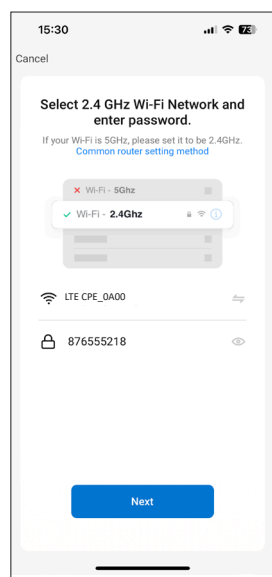

SET UP & USE

5. On the control panel of the air conditioner, press and hold the power button for 3 seconds. AP shows on the digital display. The Wi-Fi indicator light will blink.
6. Tap next to the phrase located on the bottom of the screen: "Tap when Wi-Fi indicator blinks". Tap "Next".

NOTE: If the appliance doesn't connect, repeat the process of pressing and holding the power button for 3 seconds.

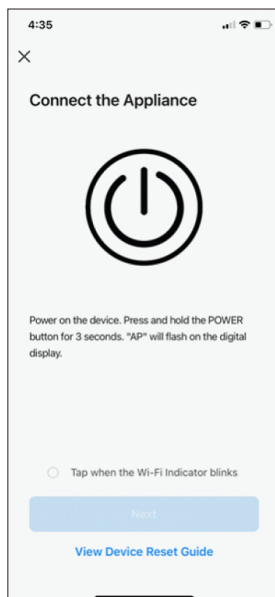

7. Wait for appliance to connect. This may take several seconds.

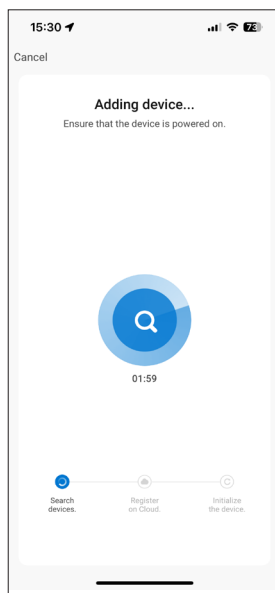

SET UP & USE

8. Once connected, the Portable Air Conditioner can be controlled by the APP.

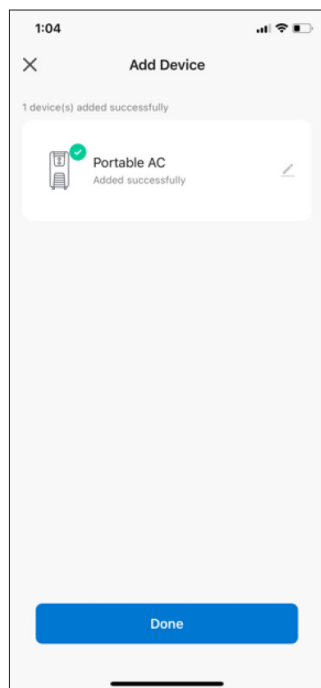

SET UP & USE

CONTROLLING THE PORTABLE AIR CONDITIONER WITH THE APP

Tap the power symbol on the top right of the screen to power on the air conditioner.

Tap “Mode”.

Select AUTO 🏠, Cool ❄️, Dry 💧, Fan 🌀

In AUTO mode the air conditioner will make automatic selections based on selected temperature and the room temperature.

Tap - or + to select temperature.

Tap “Swing” to activate air oscillation.

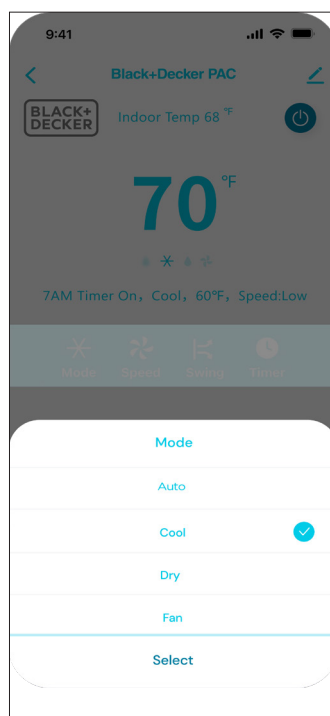
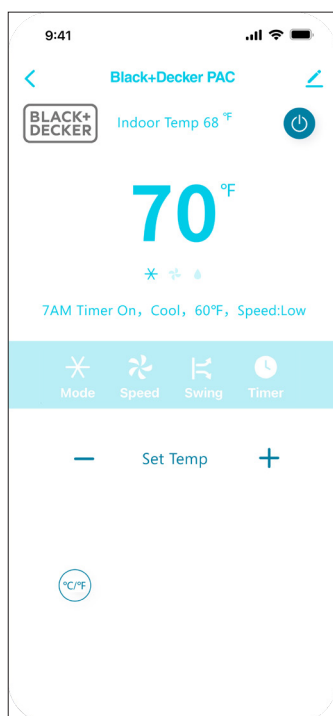

SET UP & USE

Tap Speed.
Select Auto, High, Medium or Low.

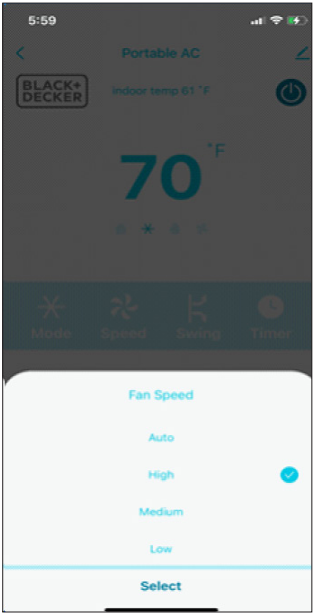
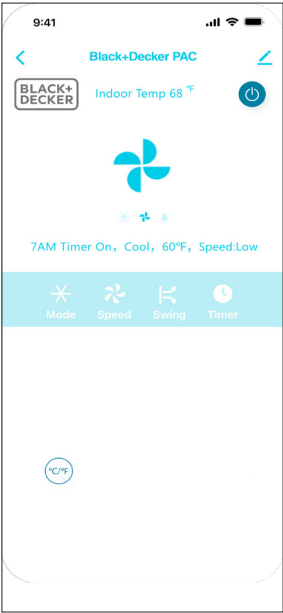

SET UP & USE

In Dry mode, the unit automatically selects a low fan speed.

An alert will indicate if the water tank needs to be drained.

See drainage instruction.

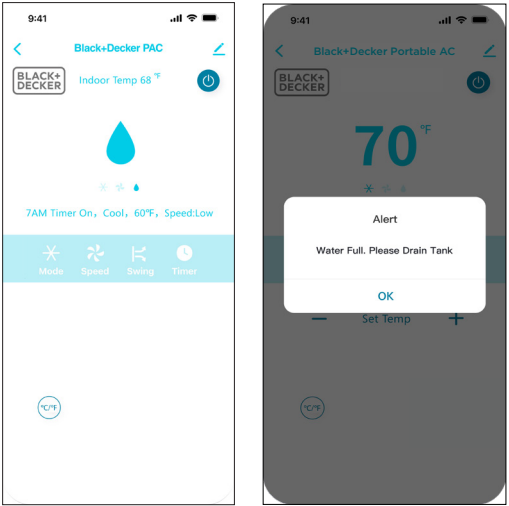

Tap Timer.

Make selections to schedule the Timer ON and OFF.

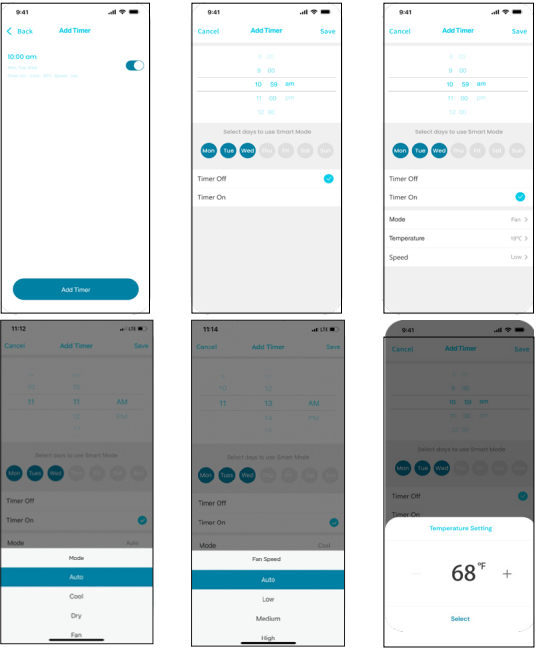

SET UP & USE

VOICE CONTROL DEVICE SETTINGS

Follow pairing instructions to connect the Air Conditioner to the Black + Decker APP using the same Wi-Fi Network.

The Default name when using voice control is “Portable AC” as shown on the top of the screens. Tap the edit symbol to to right of it in order to change the device name.

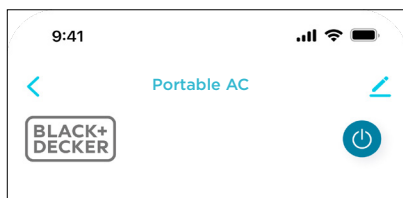

On the next screen, tap the edit symbol to right of the default name again.

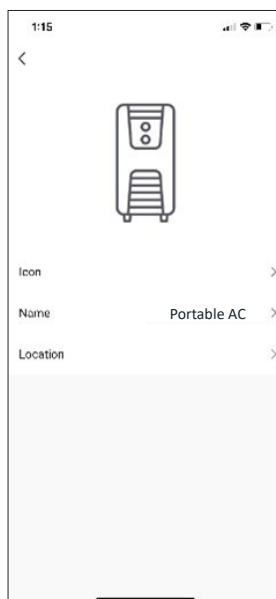
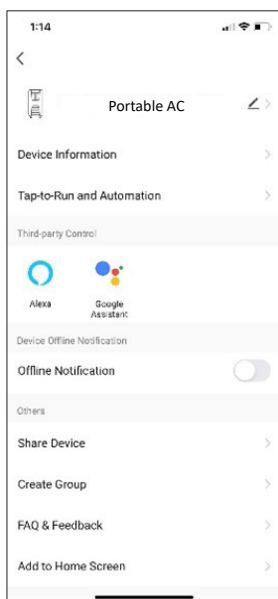

SET UP & USE

A pop up window will appear. Type in the new name.

The name should be easy to remember and different than other connected devices using voice control.

Tap "Confirm".

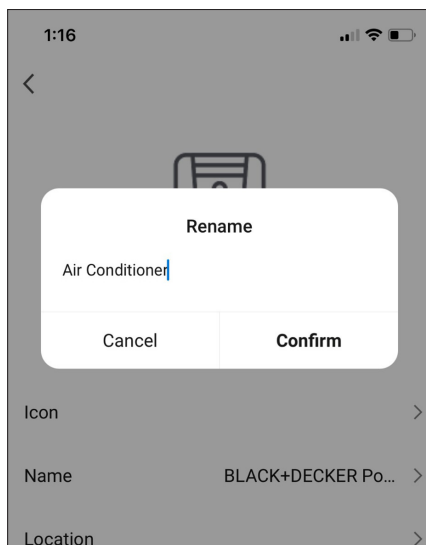

SET UP & USE

SET UP VOICE CONTROL WITH ALEXA

You will need an Alexa device such as Amazon Echo, Echo Dot set up with the Alexa APP according to manufacturer's instructions. The device should be powered on and connected to a Wi-Fi network.

On the homepage of the Black + Decker APP tap "Profile" on the bottom right corner.

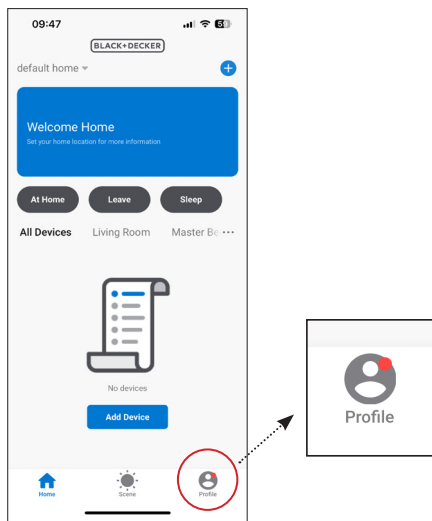

Tap "Alexa".

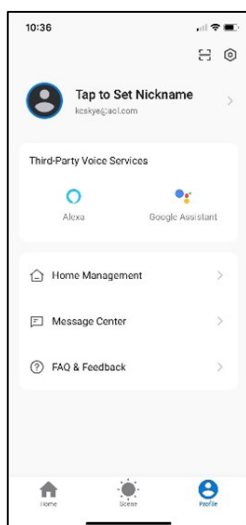

SET UP & USE

Tap “Sign in with Amazon”. Sign in and use the same password used for the Alexa APP.

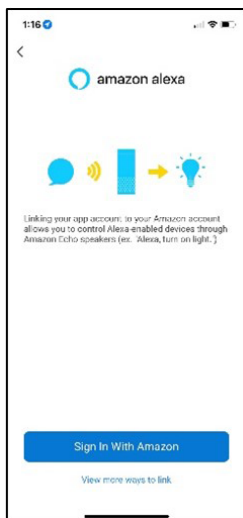

Tap “Link”.



SET UP & USE

Open the Alexa APP and enable “Smart Home Skills” for Black + Decker Home. Alexa can locate the device when you say “Alexa, discover my device”. Follow the prompts in the Alexa APP to manage the device and control the air conditioner using the voice commands.



SET UP & USE

ALEXA VOICE COMMANDS

The following examples use the device name “Portable AC”. Refer to the “Voice control device settings” section for instructions on how to change the device name.

To turn the unit ON/OFF.	“Alexa, turn on the Portable AC.” “Alexa, turn off the Portable AC.”
To find out the current indoor temperature.	“Alexa, what is the temperature of the Portable AC?” “Alexa, what is the Portable AC temperature?”
To select a mode. (Choose Auto, Cool, Dry or Fan)	“Alexa, set the Portable AC to cool.” “Alexa, change the Portable AC to dehumidifier.” “Alexa, set the Portable AC to Auto.” “Alexa, set the Portable AC to dry”
Check the current set temperature and select a set temperature. (Choose temperature values between 60°F-86°F). The unit must be set to Cool mode.	“Alexa, what is the target temperature of the Portable AC?” “Alexa, what is the Portable AC set to?” “Alexa, set Portable AC to 70°F.” “Alexa, set Portable AC to 68°F.”
Check the current fan speed and select a fan speed. (Choose fan speeds Auto, High, Medium or Low).	“Alexa, what’s the fan speed on the Portable AC?” “Alexa, set the Portable AC to high fan speed.” “Alexa, set the fan speed on the Portable AC to low.”

SET UP & USE

SET UP VOICE CONTROL WITH GOOGLE ASSISTANT

You will need a device such as Google Nest, Google Nest mini set up with the Google Home APP according to manufacturer's instructions. The device should be powered on and connected to a Wi-Fi network.

On the homepage of the Black + Decker APP tap "Profile" on the bottom right corner.

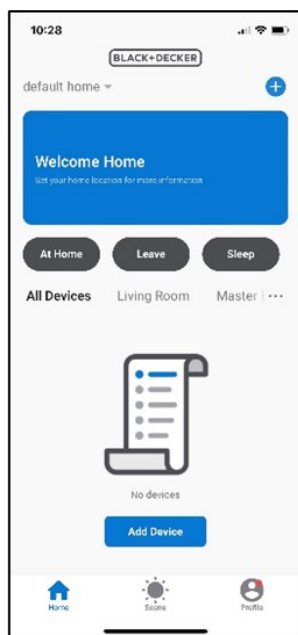

SET UP & USE

Tap “Google Assistant”.

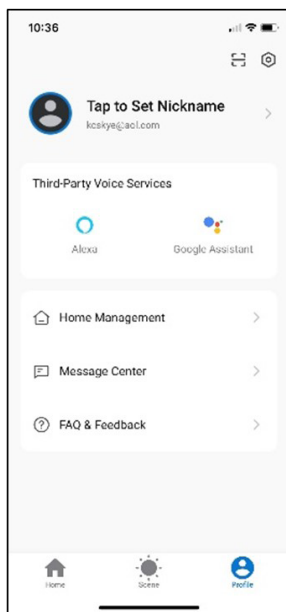

Open the Google Home App and tap settings on the bottom, right of the screen.

Tap “Works with Google”.

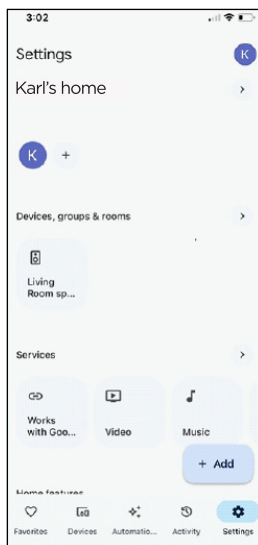

SET UP & USE

Search for “Black + Decker Home” by typing it in the search bar.

Tap to select “Black + Decker Home”.

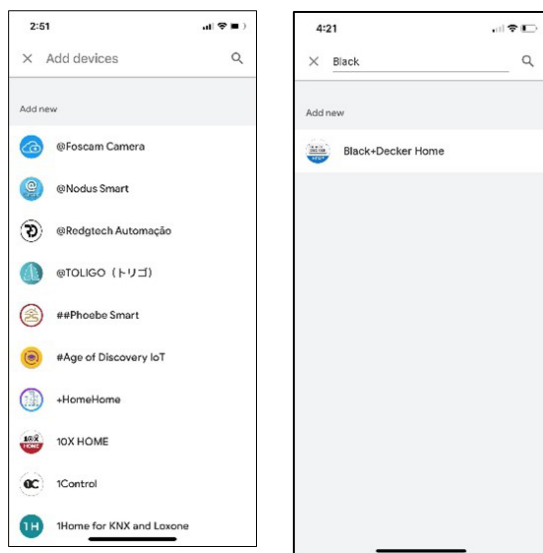

The Google APP will show prompts to link with a verification code from the Black + Decker Home APP or link with account Password. Use the same e-mail and password as the Black + Decker Home APP to complete the Authorization. Once linked, open the Google Assistant App and tap Black + Decker Home. Select “Check for new devices” Follow the Google Home prompts to control the portable air conditioner.

SET UP & USE

GOOGLE ASSISTANT VOICE COMMANDS

The following examples use the device name "Portable AC". Refer to the "Voice control device settings" section for instructions on how to change the device name.

To turn the unit ON/OFF.	"OK Google, turn on the Portable AC." "OK Google, turn off the Portable AC."
To find out the current indoor temperature.	"OK Google, what is the temperature of the Portable AC?" "OK Google, what is the Portable AC temperature?"
To select a mode. (Choose Auto, Cool, Dry or Fan)	"OK Google, set the Portable AC mode to cool." "OK Google, set the Portable AC to Auto." "OK Google, set the Portable AC mode to dry." "OK Google, set the Portable AC to fan."
Check the current set temperature and select a set temperature. (Choose temperature values between 60°F-86°F). The unit must be set to Cool mode.	"OK Google, what is the Portable AC set to?" "OK Google, set Portable AC to 70." "OK Google, set Portable AC to 68 degrees."
Check the current fan speed and select a fan speed. (Choose fan speeds, Auto, High, Medium or Low).	"OK Google, set the Portable AC to low." "OK Google, set the fan speed on the Portable AC to high." "OK Google, what is the fan speed on the Portable AC."

SET UP & USE

OPERATING FROM THE REMOTE CONTROL

BATTERY INSTALLATION (BATTERIES NOT INCLUDED)

- (1) Slide open the battery compartment cover.
- (2) Insert 2 × “AAA” batteries as shown.
- (3) Slide back the battery cover.

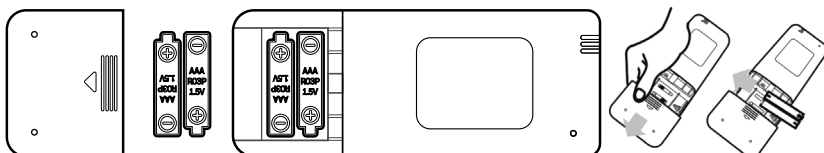

CAUTION: Use only AAA or IEC R03 1.5V alkaline batteries. Remove the batteries if the remote is not used for a month or longer. Do not attempt to recharge the batteries. Both batteries should be replaced at the same time. Do not dispose of the batteries in a fire as they may explode.

Point the remote control at the receiver on the appliance. The remote control must be no more than 7 meters away from the appliance (without obstacle between the remote control and the receiver).

The remote control must be handled with extreme care. Do not drop it or expose it to direct sun light or sources of heat.

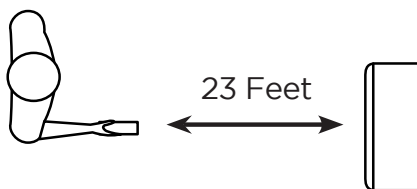

SET UP & USE

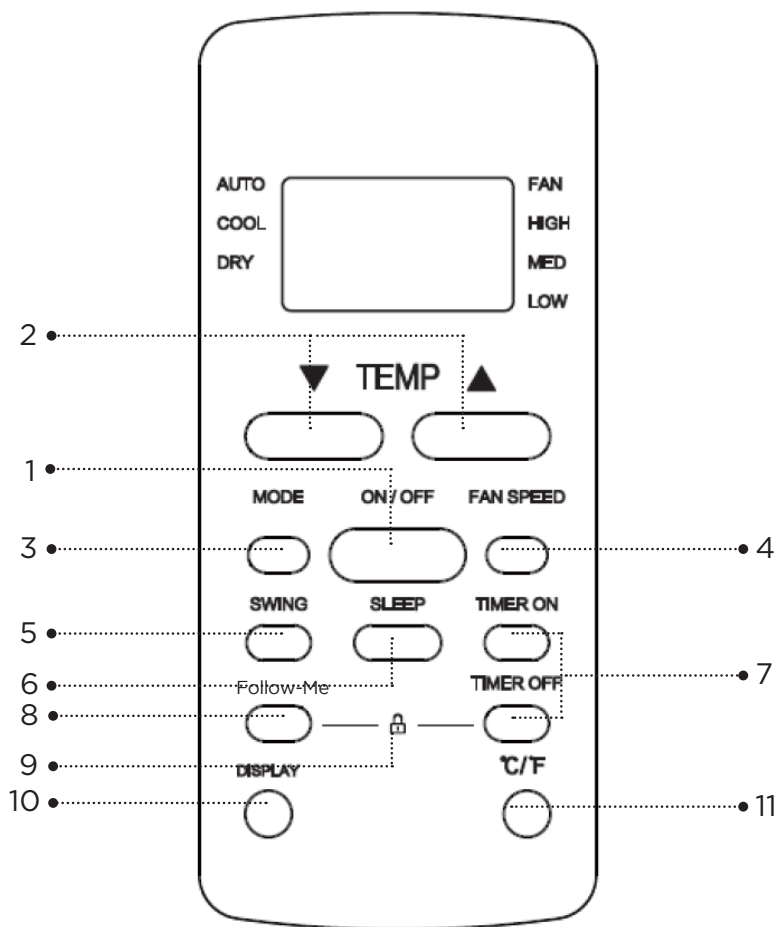

1. **ON/OFF:** Press to Turn ON or OFF.
2. Increases temperature ▼ **TEMP** ▲ in 1°F (1°C) increments. Max. temperature is 86°F (30°C).
Decreases temperature in 1°F (1°C) increments. Min. temperature is 60°F (16°C).
These buttons are also used to set time.
3. **MODE:** Press to scroll through AUTO, COOL, DRY, FAN
4. **FAN SPEED:** Used to select the HIGH, MED, LOW or AUTO fan speed.
5. **SWING:** Activates the louver to swing UP/DOWN.
6. **SLEEP:** Gradually increase temperature in COOL mode while you sleep.

SET UP & USE

7. **TIMER ON:** Set the TIMER for AUTO START.
TIMER OFF: Set the TIMER for AUTO STOP.
8. **Follow-Me:** This function can be activated from the remote control ONLY. The remote control serves as a thermostat allowing for the precise temperature control at its location.
9. **LOCK:** Press **Follow-Me** and **TIMER OFF** buttons at the same time for 5 seconds to lock the remote buttons. This can prevent inadvertently making changes to the air conditioner settings. Press **Follow-Me** and **TIMER OFF** buttons at the same time for 2 seconds to unlock the keys.
10. **DISPLAY:** Press to turn off the LED display on the device and mute the volume at the same time. This feature is only available on the remote control.
11. **°C / °F SELECTOR:** Change temperature units from Fahrenheit or Celsius.

Information is displayed when the remote controller is powered up.

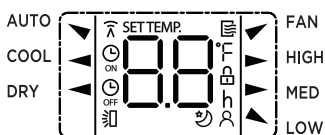

NOTE: All indicators shown are for information only. During the actual operation, only the relevant functions are shown on the LED display.

Mode display

AUTO ▼ COOL ◀ DRY ◀
▼ FAN

	Displayed when data transmitted.
	Displayed when remote controller is ON.
	Displayed when TIMER ON time is set
	Displayed when TIMER OFF time is set
	Shows set temperature or room temperature, or time under TIMER setting
	Indicateds all the current settings are locked
	Displayed when SLEEP feature is activated
	Auto swing display
	Temperature unit °C / °F Display

Fan speed indication

► HIGH	High speed
► MED	Medium speed
▲ LOW	Low speed
NO display	Auto fan speed

SET UP & USE

WATER DRAINAGE METHOD FOR COOL MODE

This air conditioner is equipped with auto water evaporation so the water compartment would not typically fill in cooling mode unless there is high humidity. Water drainage will generally only be required at the end of the season, (see START-END OF SEASON OPERATIONS).

NOTE: As a safety measure to prevent water leakage, the air conditioner will turn off when the water level reaches a predetermined level. The control panel will display "P1"(full tank). The unit will not restart until it is drained.

Continuous Draining

1. Unplug the unit from the power source. Remove the bottom drain cap. While doing this operation, some residual water may spill. Have a drip pan (not supplied) to collect the water.
2. Connect the drain hose (supplied) as shown in the diagram. The water can be continuously drained through the hose into a floor drain or drip tray.
3. Turn on the unit.

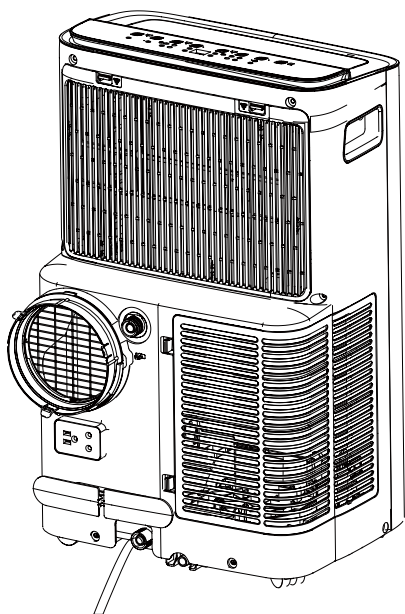

WAIT 3 MINUTES BEFORE RESUMING OPERATION

After the unit has stopped, it cannot be restarted for 3 minutes. Operation will automatically restart after 3 minutes.

SET UP & USE

NOTE: Please be sure that the height of the drain hose should not be higher than that of the drain outlet, or the water tank may not be drained.

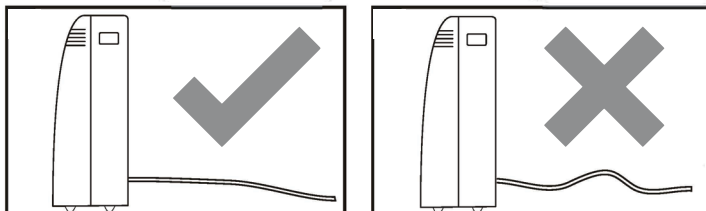

Continuous Draining for Dry Mode

- Unplug the unit from the power source.
- Remove the drain cap located in the back center of the unit. While doing this operation, some residual water may spill. Have a drip pan (not supplied) to collect the water.
- Connect the drain hose (supplied) as shown in the diagram. The water can be continuously drained through the hose into a floor drain or bucket.
- Turn on the unit.

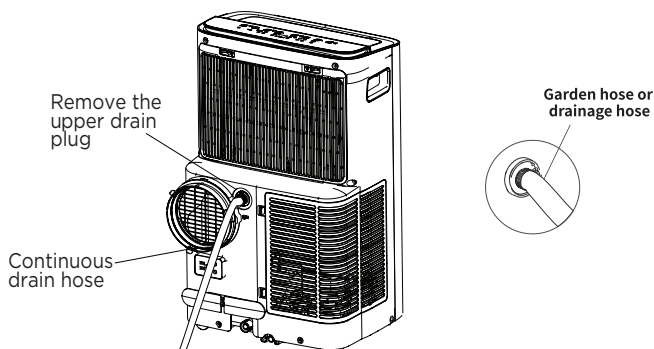

NOTE: The included drain hose can be substituted with a garden hose.

NOTE: Please be sure that the height of and section of the drain hose should not be higher than that of the drain outlet, or the water tank may not be drained.

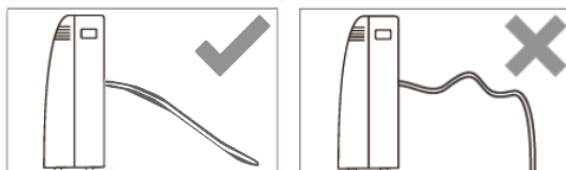

WAIT 3 MINUTES BEFORE RESUMING OPERATION

After the unit has stopped, it cannot be restarted for 3 minutes. Operation will automatically restart after 3 minutes.

CLEANING AND MAINTENANCE

CLEANING

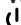
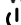

WARNING: Before cleaning or maintenance, turn the appliance off by pressing the  button on the control panel or  button on the remote control. Wait for a few minutes then unplug from the electrical outlet.

CLEANING THE CABINET

You should clean the appliance with a slightly damp cloth then dry with a dry cloth.



WARNING:

- Never use petrol, alcohol or solvents to clean the appliance.
- Never wash the air conditioner with water.
- It could be dangerous. Never spray insecticide liquids or similar.

CLEANING THE FILTERS

To keep your air conditioner working efficiently, you should clean the filters every week of operation.

The evaporator filter can be removed as shown

The condenser filter is two pieces.

STEP 1: Take out one filter as shown.

STEP 2: Take out other filter as shown.

The filter indicator light will illuminate after 250 hours of operation. Clean the filter.

To reset after cleaning the filter, press and hold the SLEEP button for 3 seconds and the light will go off.

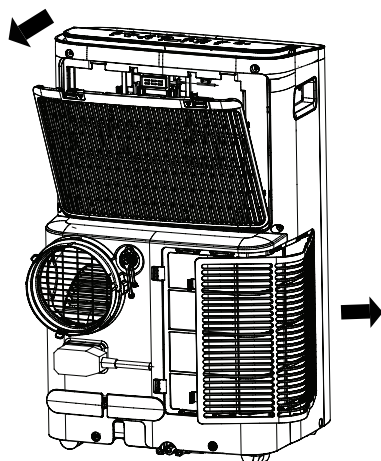

Use a vacuum cleaner to remove dust accumulations from the filters. If it is very dirty, immerse in warm water and rinse a number of times. The water should be luke warm. After washing, leave the filters to dry then re-insert.

START - END OF SEASON OPERATIONS

START OF SEASON CHECKS

Make sure the power cable and plug are undamaged. Follow the installation instructions precisely.

END OF SEASON OPERATIONS

Remove the drain caps and make sure the unit is completely drained of water.

Run off all water left into basin. When all the water has been drained, put the cap back in place.

TROUBLESHOOTING & WARRANTY

BEFORE YOU CALL FOR SERVICE

IF THE APPLIANCE FAILS TO OPERATE:

- A) Check to make sure that the Air Conditioner is plugged in securely. If it is not, remove the plug from the outlet, wait 10 seconds and plug it in again securely.
- B) Check for a blown circuit fuse or a tripped main circuit breaker. If these seem to be operating properly, test the outlet with another appliance.

IF NONE OF THE ABOVE SOLVES THE PROBLEM, CONTACT A QUALIFIED TECHNICIAN. DO NOT TRY TO ADJUST OR REPAIR THE APPLIANCE YOURSELF.

CUSTOMER SERVICE

IMPORTANT

DO NOT RETURN THIS PRODUCT TO THE STORE

If you have a problem with this product, please contact the BLACK+DECKER Customer Satisfaction Center at 844-299-0879 or service@equitybrands.com

DATED PROOF OF PURCHASE, MODEL # AND SERIAL #
REQUIRED FOR WARRANTY SERVICE

TROUBLESHOOTING & WARRANTY

Troubleshoot your problem by using the chart below. If the air conditioner still does not work properly, contact W Appliance Co. customer service center or the nearest authorized service center. Customers must never troubleshoot internal components

TROUBLE	POSSIBLE CAUSE	POSSIBLE REMEDY
Unit does not start when pressing ON/OFF button	A.P1 appears in the display window B.Room temperature is lower than set temperature (cooling mode) C.. The unit was just shut off.	A.The unit has to be drained. B.Reset the temperature C.After the unit has stopped, it cannot be restarted for 3 minutes. Operation will automatically restart after 3 minutes.
Not cool enough	A.The windows or doors in the room are not closed B. There are heat sources inside the room C.Exhaust air duct is not connected or blocked D.Temperature setting is too high E. Air filter is blocked by dust	A.Make sure all the windows and doors are closed B.Remove the heat sources if possible C.Connect the duct and make sure it can function properly D.Decrease the set temperature E.Clean the air filter.
Noisy or vibration	A.The surface is not level or not flat enough	A. Place the unit on a flat,level surface if possible
Gurgling sound	A.The sound comes from the flowing of the refrigerant inside the air-conditioner	A.It is normal
Unit stops operating	A.P1 appears in the digital display.	A.The unit has to be drained.

TROUBLESHOOTING & WARRANTY

APP AND VOICE CONTROL TROUBLESHOOTING

TROUBLE	POSSIBLE CAUSE	POSSIBLE REMEDY
Unable to register or login to account.	The Wi-Fi is not enabled on the cellphone.	Turn on the cell phone's Wi-Fi.
	Wi-Fi signal is weak.	Install a Wi-Fi extender (not included).
		Move the appliance closer to the Wi-Fi router.
Appliance is not connecting with the App.	Wi-Fi signal is weak.	Install a Wi-Fi extender (not included).
		Move the appliance closer to the Wi-Fi router.
	Location and Bluetooth are not enabled	Make sure Bluetooth is enabled on the phone and permissions are enabled. Make sure location settings are enabled. For detailed instructions see ENABLE LOCATION SETTINGS. Press and hold the power button for 3 seconds. AP shows on the digital display.. Follow the prompts in the APP.
	Wi-Fi connection frequency is incorrect.	Select a 2.4 GHz Wi-Fi network.
	The encryption method of the router's wireless setting is wrong.	Set the encryption method of the router's wireless setting to "WPA2-Psk" and the authentication type to "AES" or both are set as automatic. NOTE: 802.11n only" is not allowed in wireless mode.
Voice Control is not working.	Alexa or Google Assistant device may not be working correctly or may not be connected to the same network as the appliance.	Make sure the Alexa or Google Assistant device is working correctly and connected to the same network as the appliance. Follow the on screen prompts and troubleshooting the device.
	The Black + Decker APP Account may not be linked correctly to the voice assistant's account.	Check the voice assistant APP to make sure the correct appliance has been linked. Use the Black + Decker user name and password when prompted in the voice assistant APP to link the account.

TROUBLESHOOTING & WARRANTY

TROUBLE	POSSIBLE CAUSE	POSSIBLE REMEDY
Appliance is not connecting with the App.	The number of connected devices reached the limit of the router.	Turn off the Wi-Fi functions of some of the connected devices.
		Re-configure the router.
	The router has enabled the wireless MAC address filter.	Remove the device from the MAC address filter on the router.
		Ensure the device is not prohibited by the router to connect to the network.
App is not controlling appliance.	Wi-Fi connection has been lost.	Reconnect the appliance with the App.
	Power disruption to the appliance.	The app will no longer stay connected to the appliance 3 minutes after power failure. Restore power to the appliance and reconnect to Wi-Fi.

TROUBLESHOOTING & WARRANTY

LIMITED WARRANTY

Any repair, replacement, or warranty service, and all questions about this product should be directed to W Appliance at **844-299-0879** from the USA or Puerto Rico.

W Appliance warrants to the original purchaser that the product will be free from defects in material, parts and workmanship for the period designated for this product. The warranty commences the day the product is purchased and covers up to a period of **1 year (12 months) for labor/1 year (12 months) for parts (manufacturing defects only)/and a total of 5 years (60 months) for compressor part only.**

W Appliance agrees that it will, at its option, replace the defective product with either a new or remanufactured unit equivalent to your original purchase during the warranty period.

Exclusions: This warranty does not apply if any of the following conditions exist:

1. If the appearance or exterior of the product has been damaged or defaced, or altered or modified in either design or construction.
2. If the product original serial number has been altered or removed or cannot be readily determined.
3. If there is damage due to a power line surge, user damage to the AC power cord or connection to improper voltage source.
4. If damage is due to general misuse, accidents, or acts of God.
5. If repair attempts are done by unauthorized service agents; use of parts other than genuine parts or parts obtained from persons other than authorized service companies.
6. On units that have been transferred from the original owner.
7. On products that have been purchased as refurbished, like new, second-hand, in a "As-Is" or "Final Sale" terms.
8. To products used in a commercial or rental setting.
9. To product was used in settings other than ordinary household use or used other than in accordance with the provided instructions.
10. To damages for service calls for improper installations.
11. Transportation and shipping costs associated with the replacement of the unit.
12. Service calls to instruct you how to use your product.
13. Service calls to repair or replace the house fuse, reset a circuit breaker, or correct the wiring in the house.

REPAIR OR REPLACEMENT AS PROVIDED UNDER THIS WARRANTY IS THE EXCLUSIVE REMEDY OF THE CUSTOMER; W APPLIANCE SHALL NOT BE LIABLE FOR ANY INCIDENTAL OR CONSEQUENTIAL DAMAGES FOR BREACH OF ANY EXPRESS OR IMPLIED WARRANTY ON THIS PRODUCT, EXCEPT TO THE EXTENT PROHIBITED BY APPLICABLE LAW. ANY IMPLIED WARRANTY OF MERCHANTABILITY OF FITNESS FOR A PARTICULAR PURPOSE ON THIS PRODUCT IS LIMITED TO THE DURATION OF THE WARRANTY.

Some states do not allow the exclusion or limitations of incidental or consequential damages, or limitations on how long the warranty lasts. In these cases the above exclusions or limitations may not apply to you. This warranty gives you specific legal rights and you may also have other rights which vary from state to state.

Obtaining Service: To obtain service, product literature, supplies or accessories please call **844-299-0879** to create a ticket for exchange/repair. Please make sure to provide the date of purchase, model number and a brief description of the problem. Our customer service representative will contact you or send detailed return instructions.

W Appliance does not warrant that the appliance will work properly in all environmental conditions, and makes no warranty and representation, either implied or expressed, with respect to the quality, performance, merchantability, or fitness for a particular purpose other than the purpose identified within this user's manual. W Appliance has made every effort to ensure that this user's manual is accurate and disclaims liability for any inaccuracies or omissions that may have occurred. Information in this user's manual is subject to change without notice and does not represent a commitment on the part of W Appliance. W Appliance reserves the right to make improvements to this user's manual and/or to the products described in this user's manual at any time without notice. If you find information in this manual that is incorrect, misleading, or incomplete, please contact us at **844-299-0879**.

W Appliance Co.
1356 Broadway
New York, NY 10018



BLACK & DECKER, BLACK+DECKER, the BLACK & DECKER and BLACK+DECKER logos and product names are trademarks of The Black & Decker Corporation, used under license. All rights reserved.

Product in this box may differ slightly from that pictured. Does not affect function. Not all accessories shown in photography are included in this package.

Imported by W Appliance, Inc., 1356 Broadway, New York, NY 10018

Customer Service:844-299-0879

Dec.2024

Printed in China