

BLACK+[®]DECKER



UPRIGHT FREEZER INSTRUCTION MANUAL

CATALOG NUMBER

**BUF850LW, BUF850LB,
BUF850LS, BUF1000LW,
BUF1000LB, BUF1000LS**



Thank you for choosing BLACK+DECKER!

**PLEASE READ BEFORE RETURNING THIS PRODUCT FOR
ANY REASON.**

If you have a question or experience a problem with your BLACK+DECKER purchase, go to www.blackanddecker.com/instantanswers

If you can't find the answer or do not have access to the Internet, call 844-299-0879 from 10:30 a.m. to 6:30 p.m. EST Mon. - Fri. to speak with an agent. Please have the catalog number available when you call.

SAVE THIS MANUAL FOR FUTURE REFERENCE.

PRODUCT REGISTRATION

Thank you for purchasing our BLACK+DECKER product. This easy-to-use manual will guide you in getting the best use of your freezer.

Remember to record the model and serial numbers. They are on a label on the back of the product.

Model number

Serial number

Date of purchase

Staple your receipt to your manual.
You will need it to obtain warranty service.

SAFETY INFORMATION



DANGER

DANGER - Immediate hazards which **WILL** result in severe personal injury or death



WARNING

WARNING - Hazards or unsafe practices which **COULD** result in severe personal injury or death



CAUTION

CAUTION - Hazards or unsafe practices which **COULD** result in minor personal injury

IMPORTANT SAFETY INSTRUCTIONS



WARNING

When using electrical appliances, basic safety precautions should be followed, including the following:

READ ALL INSTRUCTIONS BEFORE USING THE UNIT

NOTE: If the freezer has been placed in a horizontal or tilted position for any period of time, wait 24 hours before plugging the unit in.

1. Use this appliance only for its intended purpose as described in this use and care guide.
2. This freezer must be properly installed in accordance with the installation instructions before it is used. See grounding instructions in the installation section.
3. Never unplug freezer by pulling on the power cord. Always grasp the plug firmly and pull straight out from the outlet.
4. Do not operate any appliance with a damaged cord or plug. Return appliance to the nearest authorized service facility for examination, repair or adjustment.
5. Unplug freezer before cleaning or before making any repairs.
Note: If for any reason this product requires service, we strongly recommend that a certified technician performs the service. Component parts shall be replaced with like components and servicing shall be done by factory authorized service personnel, so as to minimize the risk of possible ignition due to incorrect parts or improper service.
6. Do not use any electrical device or any sharp instrument in defrosting the freezer.
7. After the freezer is in operation, do not touch the cold surfaces in the freezer compartment, particularly when hands are damp or wet. Skin may adhere to these extremely cold surfaces.
8. Do not refreeze foods that have been thawed completely. The United States Department of Agriculture in Home and Garden Bulletin No. 69 reads: "...You may safely refreeze frozen foods that have thawed if they still contain ice crystals or if they are still cold-below 40°F.
 "...Thawed ground meats, poultry, or fish that have any off-odor or off-color should not be refrozen and should not be eaten. Thawed ice cream should be discarded. If the odor or color of any food is poor or questionable, discard it. The food may be dangerous to eat ... Even partial thawing and re-freezing reduce the eating quality of foods, particularly fruits, vegetables, and prepared foods. The eating quality of red meats is affected less than that of many other foods. Use refrozen foods as soon as possible, to save as much of its eating quality as you can."

SAFETY INFORMATION

9. This freezer should not be recessed or built-in in an enclosed cabinet. It is designed for freestanding installation only.
10. Do not operate freezer in the presence of explosive fumes.

SAVE THESE INSTRUCTIONS HOUSEHOLD USE ONLY





DANGER

Risk of child entrapment. Before disposing of any freezer or refrigerator, remove door(s). Leave any shelves in place so that children may not easily climb inside.

REFRIGERANT



GAS WARNINGS

-  **DANGER** - Risk of fire or explosion. Flammable refrigerant used. DO NOT use mechanical devices to defrost freezer. DO NOT puncture refrigerant tubing.
-  **DANGER** - Risk of fire or explosion. Flammable refrigerant used. To be repaired only by trained service personnel. DO NOT puncture refrigerant tubing.
-  **CAUTION** - Risk of fire or explosion. Flammable refrigerant used. Consult repair manual/owner's guide before attempting to service this product. All safety precautions must be followed.
-  **CAUTION** - Risk of fire or explosion. Dispose of property in accordance with federal or local regulations. Flammable refrigerant used.
-  **CAUTION** - Risk of fire or explosion due to puncture of refrigerant tubing; Follow handling instructions carefully. Flammable refrigerant used.

SAFETY INFORMATION

GROUNDING INSTRUCTIONS

ELECTRICAL REQUIREMENTS

In the event of malfunction or breakdown, grounding provides a path of least resistance for electric current to reduce the risk of electric shock. The appliance must be connected to a cord having an equipment-grounding conductor and a grounding plug. The plug must be plugged into an appropriate outlet that is properly installed and grounded in accordance with all local codes and ordinances.

⚠ DANGER - Improper connection of the equipment grounding conductor can result in a risk of electric shock. The conductor with insulation having an outer surface that is green with or without yellow stripes is the equipment grounding conductor. If repair or replacement of the cord or plug is necessary, do not connect the equipment-grounding conductor to a live terminal. Check with a qualified electrician or service person if the grounding instructions are not completely understood, or if in doubt as to whether the appliance is properly grounded. Do not modify the plug connected to the appliance – if it will not fit the outlet, have a proper outlet installed by a qualified electrician.

FOR GROUNDED, CORD-CONNECTED APPLIANCE RATED LESS THAN 15A AND INTENDED FOR USE ON A NOMINAL 120V SUPPLY CIRCUIT

The appliance is for use on a nominal 120V circuit and should be connected to a grounding outlet that looks like the one illustrated below. The use of a temporary adaptor is not recommended.

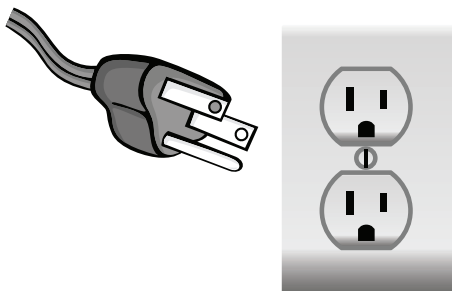

SET UP & USE

POWER SUPPLY CORD

1. Avoid the use of an extension cord because of potential safety hazards under certain conditions. Have a qualified electrician or serviceman to install an outlet near the appliance.
2. If it is absolutely necessary to use an extension cord, extreme care must be exercised.

USE OF EXTENSION CORDS WITH FREEZERS

Only use a grounded extension cord that is rated at least 15 amps and has a third-wire ground. When a long extension cord is used to connect the freezer, a voltage drop occurs. The longer the cord, the greater the voltage drop. This results in less voltage being supplied to the freezer and increases the amount of current (amp) draw or reduces performance. A heavier cord with a larger wire size will reduce the voltage drop. Be sure to choose a cord that will supply enough voltage to operate the freezer. The table below indicates appropriate gauge for extension cords.

Minimum Gauge for Cord Sets						
Ampere Rating		Volts	Total Length of Cord in Feet (meters)			
		120V	25(7.6)	50(15.2)	100(30.5)	150(45.7)
		240V	50(15.2)	100(30.5)	200(61.0)	300(91.4)
More Than	Not More Than	AWG				
0	6		18	16	16	14
6	10		18	16	14	12
10	12		16	16	14	12
12	16		14	12	Not Recommended	

 **WARNING:** Keep electrical cords in good condition. Do not use worn, bare, or frayed cords because they can cause electrical shock.

 **WARNING:** Operating equipment at low voltage can cause it to overheat. Using an excessively long extension cord can cause the cord to overheat.

NOTE: Neither BLACK+DECKER nor the dealer can accept any liability for damage to the product or personal injury resulting from failure to observe the electrical connection procedures.

SET UP & USE

INSTALLATION GUIDE

1. Unpack your freezer by removing all packaging materials like carton, base, foams, adhesive tape, etc.
2. Remove all accessories, internal packaging material used to hold shelves, ice tray, etc. in place.
3. Clean the remains of all adhesive tape used and remove all printed material supplied.
4. Install the freezer in a convenient location away from extreme heat and cold. Allow sufficient clearance between the freezer and side wall so the door(s) will open without obstruction. Freezer is not designed for recessed installation.
5. The floor on which the freezer should be placed must be flat, hard, solid, and even. The freezer should not be placed on any soft material such as foam, plastic, carpeting, etc.
6. The following are recommended minimum clearances around the freezer for proper air circulation:
Sides: 5" (127mm)
Top : 2" (50mm)
Back : 5" (127mm)
Proper air circulation will help your freezer work at maximum efficiency.

NOTE: The appliance must be correctly connected to the power supply.

CAUTION

Care should be taken during the handling moving and use of the freezer to avoid damaging the refrigerant tubing or increasing the risk of a leak.

WARNING

It is important to keep the power cord away from the compressor at the back of the freezer as during operation, the compressor can reach a high temperature and could cause serious damage to the power cord.

SET UP & USE

PROTECTION FROM HEAT AND MOISTURE

- Do not install your freezer in any location where heavy moisture is present or if the location is not properly insulated. This freezer is not designed to operate in temperature setting below 55°F.
- Location for the freezer should be on a hard surface and away from direct sunlight and heat source, e.g., radiators, baseboard heaters, cooking appliances, etc.

DOOR HANDLE INSTALLATION

- Take out the handle accessories (handle, handle decorative cover, 2pcs of M5 screws) from the plastic accessory bag. Align the handle with the mounting holes on the side that door will open. Use Phillips head screwdriver to secure screws in place and install decorative cover.

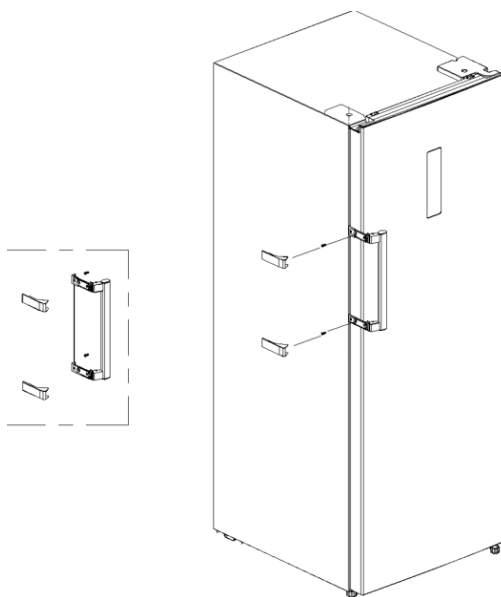

SET UP & USE

DOOR ALIGNMENT AND REVERSAL

The freezer comes with the hinge located on the right so the opening of the freezer is on the left. If you would like to change this please follow the door reversal instructions for the applicable model.

⚠ CAUTION: To avoid personal injury to yourself and / or property, we recommend someone assist you during the door reversal process.
Make sure appliance is disconnected from outlet.

DOOR REVERSAL INSTRUCTIONS

1. Use a flat head screwdriver to remove the top hinge cover.

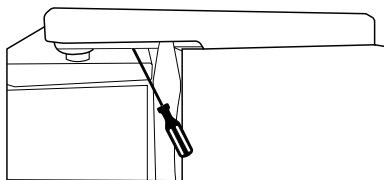

2. Loosen and remove the 3 screws holding the top hinge in place.

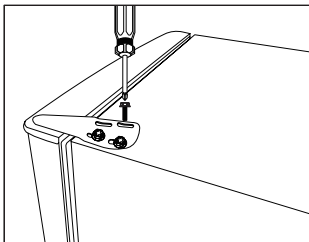

3. Remove the top hinge and carefully remove the door.
4. Remove the 3 hole plugs from the opposite side of unit and insert them in the holes of the 3 removed screws. Also remove hole plug from top of the door and move to equivalent hole on opposite side.

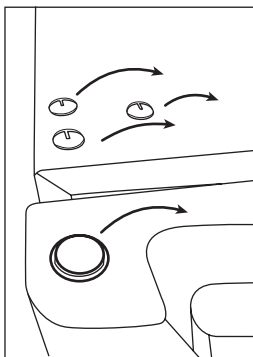

SET UP & USE

5. After removing the leveling leg and screw holding it in place, remove the bottom hinge and the 4 screws.

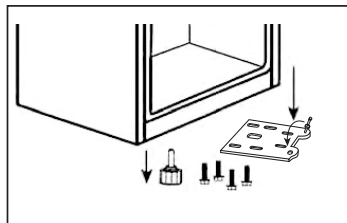

6. Remove the pin, nut and washer from the lower hinge and reinstall the pin nut and washer once the hinge has been moved to the other side as shown below.

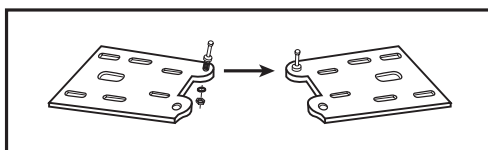

7. Remove the leveling leg and screw holding it in place from opposite side of the cabinet. Move the bottom hinge to the opposite side of the freezer, aligning with the holes, and tighten the four screws securely.

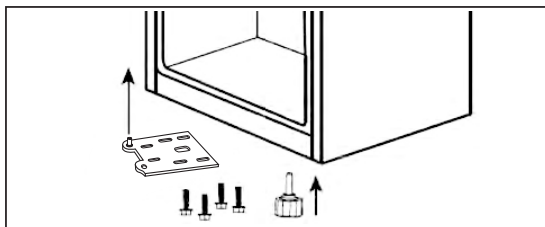

8. Take the shaft at bottom of the freezer door and pass it thru the hole in the hinge shaft.
9. Reinstall leveling legs on both sides and make sure they are securely tightened.
10. Reinstall the top hinge with the 3 previously removed screws.

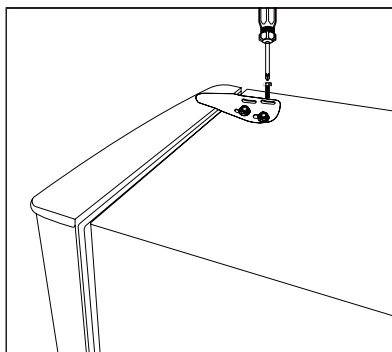

SET UP & USE

12. Make sure the top of the door is aligned with the cabinet and provides a tight seal with the gasket before tightening screws. If door is not aligned properly and does not provide a tight seal with the gasket, loosen the screws on the hinges on top of the door. Reposition the door and retighten all the screws.
13. Install the top hinge cover by aligning the back of the cover first and pushing down.

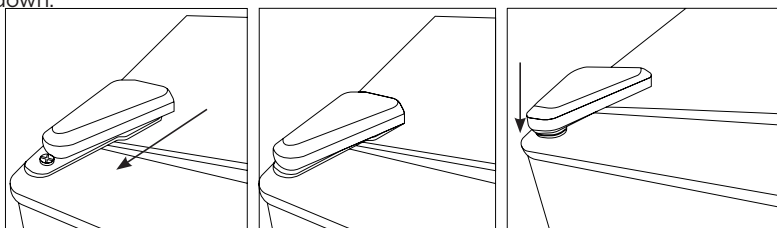

SWITCHING DOOR HANDLE

- A. To remove the handle, use an allen wrench to loosen the short fastener screws.
- B. Twist out the connection screw.
- C. On the opposite side of the door remove the screw hold plugs carefully as to not scratch the surface of the appliance. You can insert a thin piece of plastic or card underneath to lift up the screw hole plugs and remove.
- D. Reinsert the screw hole plugs on the opposite side of the door.
- E. Reinstall the handle to the opposite side of the door using the previously removed connection screws and short fastener screws.

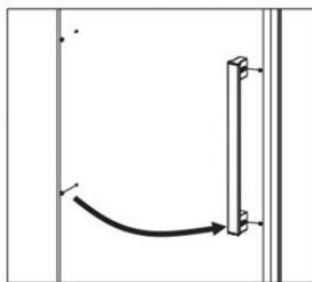
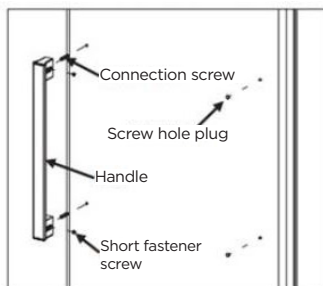

STARTING YOUR NEW FREEZER

1. After cleaning your freezer thoroughly, wipe the outside with a soft dry cloth, the interior with a clean moist cloth.
2. Insert the power supply cord into the electrical outlet.
3. Turn the thermostat dial to an initial setting of "7" for 24 hours and then set the freezer to your desired setting.

NOTE: As the door gets pressed in during shipping, the gasket may have to be reset. This is done to prevent the cool refrigerated air from escaping. If there is a gap between the door gasket and the cabinet, set the gasket by gently pulling it out of the seal gap.

SET UP & USE

PARTS & FEATURES

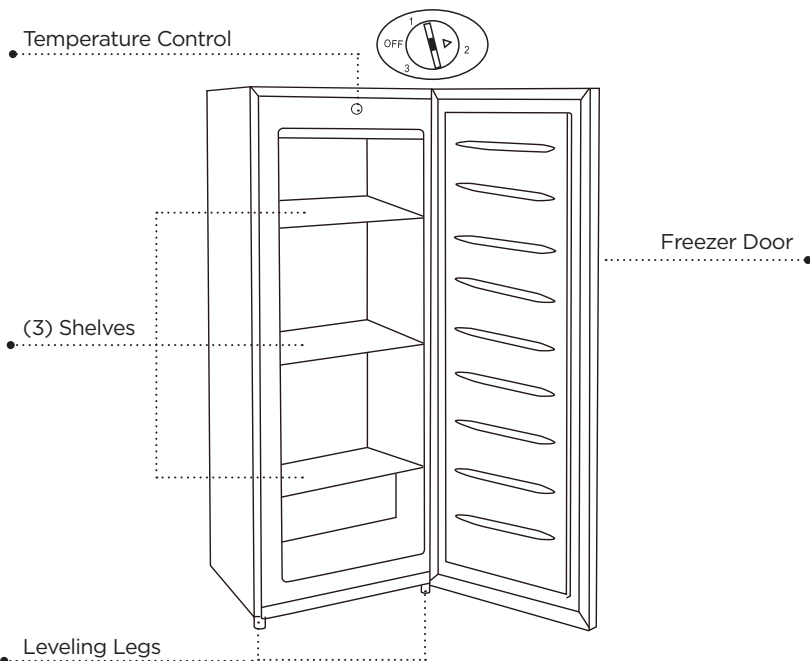

OPERATION INSTRUCTIONS

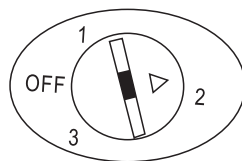

TEMPERATURE CONTROL

NOTE: If the freezer has been placed in a horizontal or tilted position for any period of time wait 24 hours before plugging the unit in.

- The settings of the temperature control are OFF, 1 (warmest), 2, 3 (coldest). Adjust the temperature control to the setting that best suits your needs.
- Turning the temperature to “OFF” position will shut off the cooling cycle, but does not turn off electrical power to the unit.

NOTE:

- Wait 3-5 minutes before restarting if you unplug the freezer. The unit may fail to operate properly if restarted too quickly.
- If the ambient temperature is too high, the freezer may not reach the desired target temperature.
- Large amounts of food will lower the cooling efficiency of the appliance.
- Do not place food on the air outlet and leave spaces for airflow.
- If you choose to change the thermostat setting, adjust thermostat control one increment at a time. Allow several hours for temperature to stabilize between adjustments.

SET UP & USE

DEFROSTING & DRAINING

- Defrost whenever the frost becomes $\frac{1}{8}$ " thick. Never use a sharp or metallic instrument to remove the frost as it may damage the cooling coils.
NOTE: A punctured coil will void the warranty.
- Turn the temperature control to OFF position and unplug the unit. Remove all contents from the freezer and leave the door open until the ice and frost melts thoroughly. Make sure a drip tray (not included) is in place. After defrosting, empty water from the drip tray and wipe the compartment dry with a soft cloth.

DANGER

Risk of child entrapment. Keep children away from freezer while defrosting.
Leave any shelves in place so that children may not easily climb inside.

NOTE: Monitor the container under the drain to avoid overflow.

- Wipe the interior of the freezer and replace the electrical plug in the electrical outlet.
- Reset the temperature control to the desired setting.

NOTE: • In case you want to speed up the defrosting, you may put a bowl of warm water (about 122°F) into the freezer.

- Do not heat the evaporator directly with hot water or hair dryer while defrosting. Doing so will damage the freezer compartment.
- Never use a sharp or metallic instrument to remove frost as it may damage the freezer and puncture the cooling coils. It will also void the warranty. We recommend using a plastic scraper.

DOOR GASKET

Clean door gaskets every three months according to general instructions. Gasket must be kept clean and pliable to assure a proper seal.

- Petroleum jelly applied lightly on the hinge sides of gaskets will keep the gasket pliable and ensure a good seal.

VACATION AND MOVING CARE

- When going on vacation, it is best that you empty all the food from your freezer. Set the temperature dial to "OFF" and unplug the freezer. Clean the unit as per "Cleaning Method" and leave the door open to remove any odors. .
- When travelling or moving the freezer, always transport the unit vertically. Moving the unit on its sides may damage the freezer and/or its compressor.

CLEANING AND CARE

CLEANING AND MAINTAINING

The freezer should be cleaned and maintained once a month. Before doing so, you must unplug the freezer.

CAUTION

To avoid personal injury or product damage always read and follow manufacturer's instructions and warnings before using any cleaning products.

WARNING

Always unplug your freezer before cleaning to avoid electric shock. Ignoring this warning may result in death or injury

POWER INTERRUPTION

In case of a power interruption/outage, unplug the power cord from the wall outlet. Replug the power cord to the wall outlet once the power has been restored. For long period of power outage, inspect and discard the spoiled or thawed foods from the freezer and freezer compartments. Clean the freezer thoroughly before using again.

CLEANING METHOD

Prepare a cleaning solution of 3-4 tablespoons of baking soda mixed with warm water. Use sponge or soft cloth, dampened with the cleaning solution to wipe down your freezer.

- Rinse with clean warm water and dry with a soft cloth,
- Do not use harsh chemicals, abrasives, ammonia, chlorine bleach, concentrated detergents, solvents or metal scouring pads. Some of these chemicals may dissolve, damage and/or discolor your freezer.

DOOR GASKET

Clean door gaskets every three months according to general instructions.

Gasket must be kept clean and pliable to assure a proper seal.

- Petroleum jelly applied lightly on the hinge sides of gaskets will keep the gasket pliable and ensure a good seal.

CLEANING AND CARE

ENERGY SAVING TIPS

- The freezer should be located in the coolest area of the room, away from heat-producing appliances or heating ducts, and out of direct sunlight.
- Let hot foods cool to room temperature before placing in the freezer. Overloading the freezer forces the compressor to run longer and thus increase energy consumption. Foods that refrigerate too slowly may lose quality or spoil.
- Be sure to wrap foods properly, and wipe containers dry before placing in the freezer.
- The shelves should not be lined with aluminium foil, wax paper, or paper towels. This will interfere with cold air circulation, making the freezer less efficient.
- Organize food to reduce door openings and extended searches. Remove as many items as needed at one time, and close the door as soon as possible.



WARNING: DO NOT TRY TO REPAIR THE FREEZER YOURSELF.

TROUBLESHOOTING & WARRANTY

BEFORE YOU CALL FOR SERVICE

IF THE FREEZER FAILS TO OPERATE:

- A) Check to make sure that the freezer is plugged in securely. If it is not, remove the plug from the outlet, wait 10 seconds and plug it in again securely.
- B) Check for a blown circuit fuse or a tripped main circuit breaker. If these seem to be operating properly, test the outlet with another appliance.

IF NONE OF THE ABOVE SOLVES THE PROBLEM, CONTACT A QUALIFIED TECHNICIAN. DO NOT TRY TO ADJUST OR REPAIR THE FREEZER YOURSELF.

CUSTOMER SERVICE

IMPORTANT

DO NOT RETURN THIS PRODUCT TO THE STORE

If you have a problem with this product, please contact the **BLACK+DECKER** Customer Satisfaction Center at 844-299-0879 or service@appliance.com.

**DATED PROOF OF PURCHASE, MODEL # AND SERIAL #
REQUIRED FOR WARRANTY SERVICE**

TROUBLESHOOTING & WARRANTY

TROUBLESHOOTING

Troubleshoot your problem by using the chart below. If the freezer still does not work properly, contact BLACK+DECKER customer service center or the nearest authorized service center. Customers must never troubleshoot internal components.

TROUBLE	POSSIBLE CAUSE	POSSIBLE REMEDY
Freezer does not work.	A. Freezer is not switched on. B. Unit is not plugged in or is loose. C. Fuse has blown or is defective. D. Wall power socket is defective.	A. Turn on the temperature control dial. It may be in the OFF position. B. Plug in the freezer. C. Check fuse, replace if necessary. D. To be corrected by a qualified electrician.
The food is too warm.	A. Temperature is not properly adjusted. B. Top lid was open for an extended period. C. A large quantity of warm food was placed in the freezer within the last 24 hours. D. The freezer is near a heat source.	A. Set the temperature control dial to a cooler setting. B. Open the top lid only as long as necessary. Check door gasket for proper seal. C. Set the temperature control dial to a colder setting temporarily. D. Please look in the "Protection From Heat and Moisture" section.
Heavy build-up of frost, possibly also on the top lid seal. NOTE: This is normal during high humidity periods. Frequent door openings will also cause heavy frost buildup.	A. Top lid seal is not air-tight.	A. Carefully warm the leaking sections of the top lid gasket with a hair dryer (on a cool setting). At the same time, shape the warmed top lid seal by hand such that it sits correctly.
Popping or cracking sounds.	A. When compressor comes on.	A. This is a normal sound of coolant flowing through condenser coils.
Freezer door does not shut properly.	A. Possible blockage from food containers or baskets.	A. Ensure nothing is blocking the door.
Freezer has an odor.	A. Foods not properly sealed. B. Interior needs cleaning.	A. Removed any contaminated foods. B. Please refer to "Cleaning and Care" section.

LIMITED WARRANTY

ACTIVATE WARRANTY

Any repair, replacement, or warranty service, and all questions about this product should be directed to W Appliance Co. at 844-299-0879 from the US, including Puerto Rico, or Canada.

Some issues can be addressed without service. Before contacting regarding your warranty, please visit the "Troubleshooting" section of your user manual.

All warranty service is provided exclusively by our authorized W Appliance Co. service providers. For service in US, including Puerto Rico, and Canada call 1-844-299-0879 to create a ticket. When calling, please have the following information available: date of purchase, model number, proof of purchase and a brief description of the problem.



WHAT IS COVERED

YOUR SOLE AND EXCLUSIVE REMEDY UNDER THIS LIMITED WARRANTY SHALL BE PRODUCT REPAIR AS PROVIDED HEREIN. This limited warranty is valid only in the United States or Canada and applies only when the major appliance is used in the country in which it was purchased:

ONE (1) YEAR FROM THE DATE OF DELIVERY OF THE ORIGINAL PURCHASE (PARTS AND LABOR INCLUDED):

W Appliance Co. will pay for factory-specified replacement parts and labor to correct defects in materials or workmanship that existed when this major appliance was purchased, or at its sole discretion, replace the product with a new, or remanufactured, unit equivalent to your original purchase. In the event of product replacement, your appliance will be warranted for the remaining term of the original unit's warranty period.

YEARS TWO (2) THROUGH FIVE (5) FROM DATE OF DELIVERY OF THE ORIGINAL PURCHASE (CERTAIN COMPONENT PARTS ONLY - LABOR NOT INCLUDED): W Appliance Co. will pay for factory-specified replacement parts for the component parts listed below to correct non- cosmetic defects in materials or workmanship in these parts that prevent function of this major appliance and that existed when this major appliance was purchased:

DISHWASHER	WASHING MACHINE	DRYER	REFRIGERATORS AND FREEZERS	MICROWAVE
Lower, Upper and Third Level (where applicable) Wire Racks (excludes cup shelves, silverware basket, and third rack trays), Chopper Blade, Stainless Steel Tub and Inner Door Liner	Drive Motor (Stator and Rotor Only)	Drive Motor Only	Compressor Only	Magnetron Tube Only

LIMITED WARRANTY

WHAT IS NOT COVERED / EXCLUSIONS

1. Commercial, non-residential or multiple family use or use inconsistent with the product instructions and manuals.
2. In-home instruction on how to use your product.
3. Repair to correct improper maintenance, installation not in accordance with installation instructions or electrical or plumbing codes, or repair of household electrical or plumbing systems.
4. Consumable parts (e.g., light bulbs, batteries, air or water filters, preservation solutions, etc.).
5. Defects or damage resulting from accident, misuse, abuse, alteration, fire, floods, acts of God or improper installation.
6. Damages, defects, or repairs caused by unauthorized servicers or use of non-genuine or third-party parts.
7. Any damage to the finish of appliance or home incurred during installation, including but not limited to floors, cabinets, walls, etc.
8. Cosmetic damage (e.g., scratches, dents, chips, and other damage to appliance finishes), unless such damage results from defects in materials and workmanship and is reported to W Appliance Co., within 48 hours from date of delivery.
9. If the appearance or exterior of the product has been damaged or defaced, altered or modified in design or construction.
10. Discoloration, rust or oxidation of surfaces resulting from caustic or corrosive environments (e.g., high salt concentrations, high moisture or humidity or exposure to chemicals).
11. Product pick-up or delivery. This warranty is for in-home repair only.
12. Travel or transportation expenses for service in remote locations where an authorized servicer is not available.
13. Products not accessible to provide required service or for expenses making the product accessible for servicing.
14. Surcharges including but not limited to, any after hour, weekend, or holiday service calls, tolls, ferry trip charges, or mileage expenses for service calls to remote areas, including the state of Alaska.
15. Repair, removal or reinstallation of inaccessible appliances or built-in fixtures (e.g., trim, decorative panels, flooring, cabinetry, islands, countertops, drywall) that interfere with servicing, removal or replacement of the product.
16. Appliances with original, factory installed model/serial numbers removed, altered or not easily determined.
17. Incidental or consequential damages (e.g., loss of food or medicine) resulting from appliance breakdown or delay in service, repair or replacement.
18. Transportation and shipping costs associated with the replacement of the unit.
19. Glass parts and other accessory items included with the unit.
20. Products that have been purchased as refurbished, like new, second-hand, under "as is" or "final sale" terms.
21. Units that have been transferred from the original owner/purchaser.
22. If there is damage due to power line surge, user damage to the AC power cord or connection to improper voltage source.
23. Products which are not defective or broken, or which are working as described in the owner's manual.

DISCLAIMER OF IMPLIED WARRANTIES

Repair or replacement as provided under this warranty is the exclusive remedy to the customer. W. Appliance Co. shall not be liable for any incidental or consequential damages for breach of any express or implied warranty on this product, except to the extent prohibited by applicable law. Any implied warranties, including any implied warranty of merchantability or implied warranty of fitness for a particular purpose, are limited to the duration of this warranty or the shortest period allowed by law. Some states do not allow the exclusion or limitations of consequential damages, or limitations on how long the warranty lasts. In these cases, the above exclusions or limitations may not apply to you. This warranty gives you specific legal rights and you may also have other rights which may vary from state to state.

W. Appliance Co. does not warrant that the appliance will work properly in all environmental conditions and makes no warranty and representation, either implied or expressed, with respect to the quality, performance, merchantability, or fitness for a particular purpose other than the purpose identified within this user's manual. W Appliance Co. has made every effort to ensure that this user's manual is accurate and disclaims liability for any inaccuracies or omissions that may have occurred. Information in this user's manual is subject to change without notice and does not represent a commitment on the part of W Appliance Co. W Appliance Co. reserves the right to make improvements to this user's manual and/or to the product described at any time without notice. If you find information in this manual that is incorrect, misleading or incomplete, please call 844-299-0879.

W Appliance Co.
New York, NY 10018

EXTENDED WARRANTY COVERAGE

Protect Your Appliance with Extended Warranty Coverage

Thank you for purchasing your new appliance! Your product comes with our one-year limited warranty, but why stop there? With our Extended Warranty and Accidental Damage Protection Plan, provided by Mulberry, you can ensure your appliances are covered for longer—without worrying about unexpected breakdowns or accidents.

Why Upgrade to the Extended Warranty Plan?

- **Comprehensive Protection** – Extend your warranty coverage and get full protection for accidental damage and mechanical/electrical failures, giving you peace of mind well beyond the first year.
- **No Hidden Costs** – You won't pay any deductibles or service fees for repairs or replacements. We've got you covered!
- **Avoid Expensive Repairs** – Appliances like refrigerators, air conditioners, and dishwashers can be costly to repair. Keep your products running smoothly without the worry of unexpected repair bills.
- **Quick & Easy Claims** – Mulberry offers hassle-free claims and quick, reliable service when you need it most—no complicated paperwork, just fast and efficient help.



Coverage	Basic Warranty	Protection +
Mechanical / Electrical Failure Coverage	Yes (1 year)	Yes (2 - 4 years)
Service Fee or Deductible	Yes (may apply)	No
Parts & Labor Costs Covered	Yes (limited to 1 year)	Yes (2 - 4 years)
Hassle-Free Claims Process	Standard	Priority (faster service)
Repair / Replacement Options	Yes (limited to 1 year)	Yes (2 - 4 years)
Convenience & Peace of Mind	Limited to 1 year	Guaranteed for up to 4 years

BLACK & DECKER, BLACK+DECKER, the BLACK & DECKER and BLACK+DECKER logos and product names are trademarks of The Black & Decker Corporation, used under license. All rights reserved.

Product in this box may differ slightly from that pictured. Does not affect function. Not all accessories shown in photography are included in this package.

Imported by W Appliance, Inc., 1356 Broadway, New York, NY 10018